



Installation

UHRA-IN-1A

Library	Service Literature
Product Section	Air Terminal Devices & Heat Products
Product	Unit Heaters - Electric
Model	UHRA
Literature Type	Installation
Sequence	1A
Date	April 1997
File No.	SV-TD-UH-UHRA-IN-1A-497
Supersedes	UHRA-IN-1-694

Electric Hose Down Corrosion Resistant Unit Heaters Model UHRA

General Information

Table of Contents

- 3 Special Instruction Requirements for UHRA Series Heaters
Column/Wall Mounting Kit
- 3 Instructions for all UHRA Heater Cabinet Sizes
- 4 Combination Wall to Ceiling Mount
Bracket for UHRA Heaters, 3.3 to 15 KW
- 5 Pipe Mounting Kit Instructions for UHRA Heaters Cabinet
Sizes #1 and #2, 3.3 to 15 KW units
- 5 Installation of Attachment Assembly to the Heater
- 6 Pipe Mounting Kit Instructions for UHRA Heaters Cabinet
Sizes #3 and #4, 20 to 48 KW units
- 6 Installation of Attachment Assembly to the Heater
- 7 Hanging Mounting Kit Instruction Sheet for UHRA Heaters

Installation Instructions

Special Instruction Requirements for UHRA Heaters

1. This heater should only be installed by qualified personnel.
2. Supply connections must meet NEC, CEC and all local requirements and be suitable for use in wet or corrosive locations.
3. This heater is provided with a fan delay relay which will maintain fan operation for approximately 2-1/2 minutes (150 s) after the heating cycle has ended. Never turn the heater off by any disconnect switch while heater is in operation. Always allow the fan to complete purge cycle before turning the power off.
4. Never attempt to clean or wash this unit unless all power disconnects have been opened.

For additional information see Instruction Manual provided.

Column/ Wall Mounting Kit Instructions for All UHRA Heater Cabinet Sizes

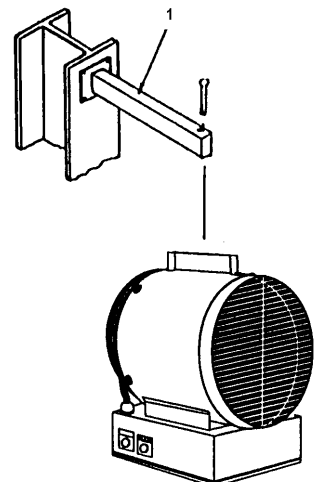
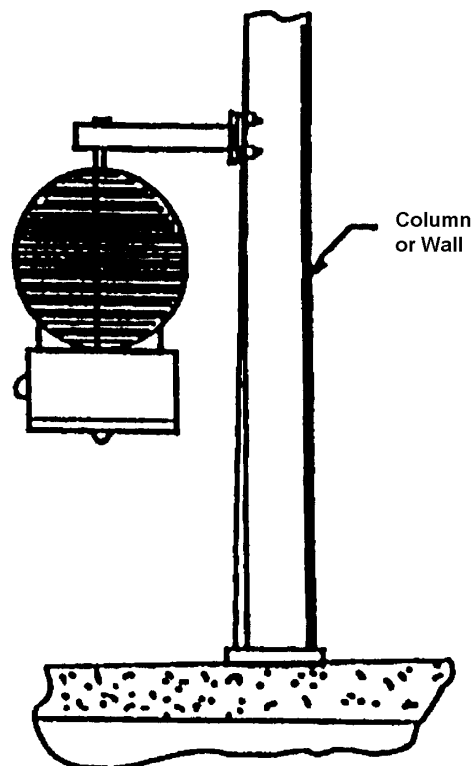
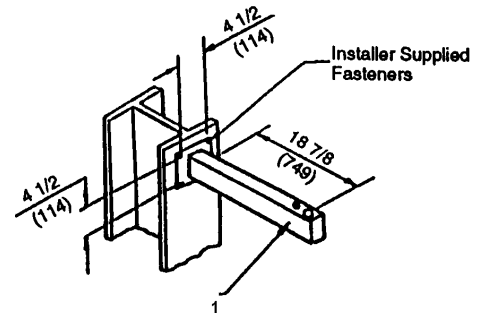

Installation Instructions

Combination Wall to Ceiling Mount Bracket for UHRA Heaters, 3.3 KW through 15 KW

Model A5520

Minimum Mounting Distances

“ A ” From Ceiling

“ B ” From Walls

Swivel hanger bracket can be used to suspend heater from either the wall (Fig. 1) or the ceiling (Fig. 2).

1. Attach the bracket to the wall or ceiling using lag screws or other suitable means (supplied by others).
2. Lift heater into position and insert bolt and washer through holes provided, place remaining washer and locknut on bolt and tighten to within two turns of being tight.
3. Swivel heater to desired position, then tighten locknut.

“ A ”

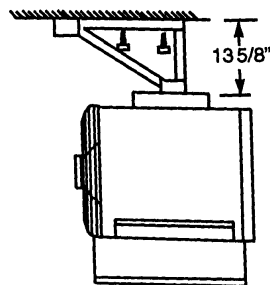
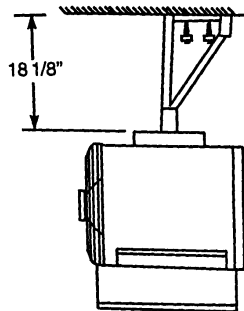

“ B ”

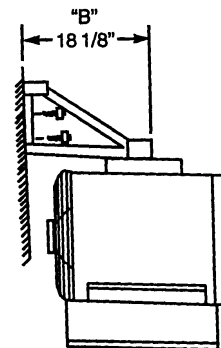

Installation Instructions

Pipe Mounting Kit Instructions For UHRA Heaters Cabinet Sizes #1 And #2

Kit Contents		
No.	Description	Qty.
1	Arm Assembly, Mtg.	1
2	Base Assy. Mtg. Column	1
3	Bracket, Column Stabilizer	1
4	#414 - 3-1/2 U-Bolt	3*
5	3/8 dia x 2-3/4 Expansion Bolt	2*
6	Angle, Stabilizer	1
7	Package, Hardware	1

(* Supplied with hardware item 7)

Note: The installer must provide a suitable length of 3-1/2" (89 mm) nominal pipe size (4" O.D.) (102 mm). Schedule 40 pipe for column mounting. Alternatively, the support arm may be bolted directly to any suitable vertical surface. Refer to drawing.

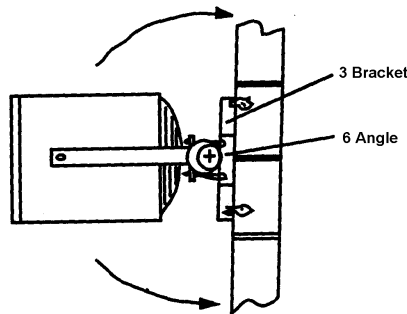

3 1/2" (89mm) Plan View The kit design allows full 360° rotation of the arm assembly. The height from the ground is adjustable. The pipe column may be adjusted from the wall within the range of 5/8" (16 mm).

Installation of Attachment Assembly to the Heater

UHRA heaters are provided with a bracket located on the top of the unit for mounting. Each bracket is provided with two 15/32 in. (12 mm) dia. holes for attachment bolts.

The heater is to be suspended on the 4-1/2 in. (114 mm) bolt from the arm as shown below. If a long section of pipe is used, it may be necessary to provide a stabilizer tie/strut near midpoint.

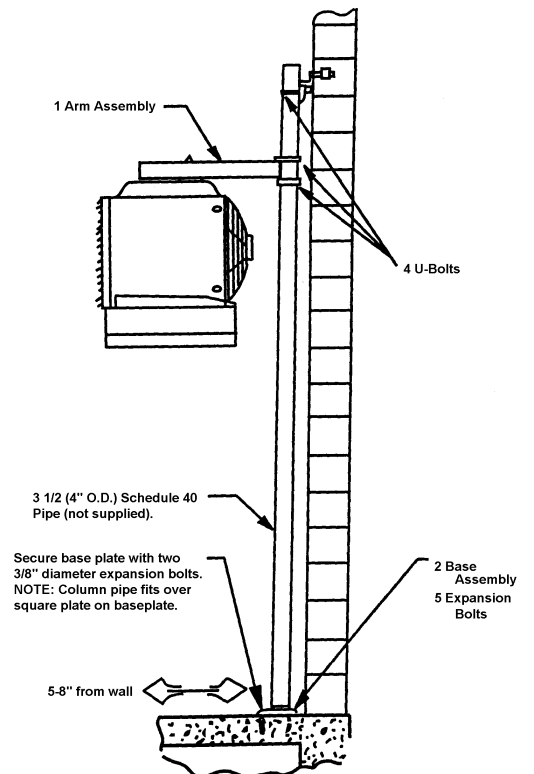
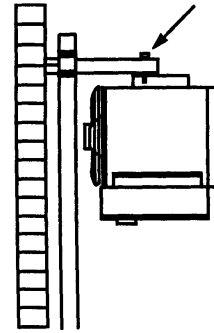

3 1/2" (89mm) Pipe Mounting

Installation Instructions

Pipe Mounting Kit Instructions for UHRA Heaters Cabinet Sizes #3 And #4

8 Channel Hanger Bracket	
Heater Cabinet	KW Range
#3	20 - 30
#4	40 - 48

Kit Contents		
Item	Description	Qty.
1	Arm Assembly, Mtg.	1
2	Base Assy. Mtg. Column	1
3	Bracket, Column Stabilize	1
4	#414 3-1/2 UBolt	3*
5	3/8 dia. x 2-3/4 Expansion Bolt	2*
6	Angle, Stabilizer	1
7	Package, Hardware	1
8	5/8" - 11 x 4-1/2" hex bolt	1*

(* Supplied with hardware item 7)

Note: Each kit contains one attachment assembly appropriate for the type of heater to be installed. See table for brackets.

Note: The installer must provide a suitable length of 3-1/2" (89 mm) nominal pipe size (4" O.D.)(102 mm) . Schedule 40 pipe for column mounting. Alternatively, the support arm may be bolted directly to any suitable vertical surface. Refer to drawing.

The kit design allows full 360° rotation of both the arm assembly and of the heater relative to the arm. The height from the 1" (25 mm) ground is adjustable.

The pipe column may be adjusted from the wall within the range of 5/8" (16 mm).

Installation of Attachment Assembly to the Heater

UHRA heaters are provided with a bracket located on the top of the unit for mounting. Each bracket is provided with a 1/2 in. (13 mm) dia. hole for attachment bolts. The attachment arm pivot is not centered and should be attached to the heater with the shorter side adjacent to the rear of unit.

If a long section of pipe is used, it may be necessary to provide a stabilizer tie/strut near midpoint.

3 1/2" (89mm) Pipe Mounting

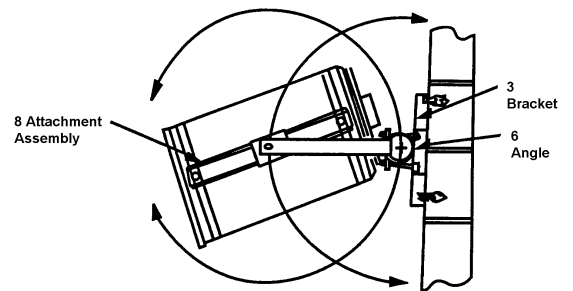
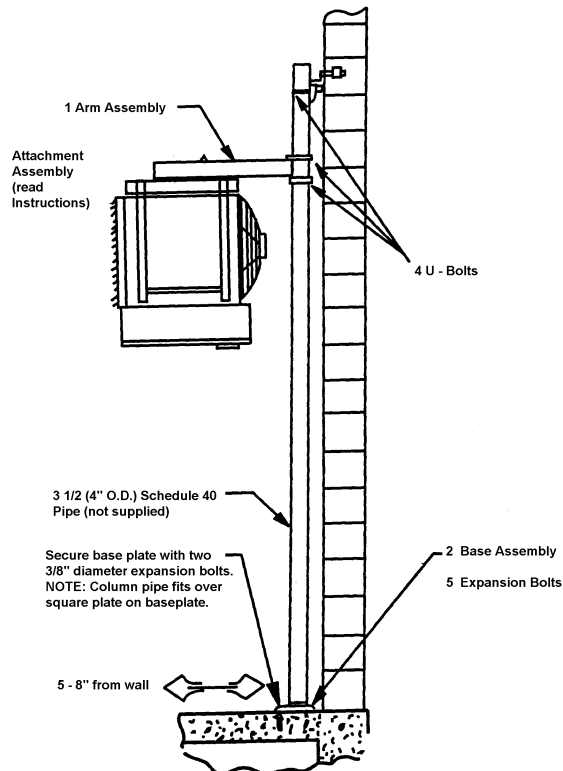

Plan View

Installation Instructions

Hanging Mounting Kit Instruction Sheet for UHRA Heaters

WARNING!
Do not install in buildings that are to be transported. Install only when building has reached its final destination.

Refer to heater installation manual for mounting specifications and conditions.

Installer required to supply the following items:

- a. Method to fasten Angle Hangers to supporting structure. The kit has provisions for four (4) 3/8" (10 mm) diameter grade 5 bolts. However, any method providing the same or better strength may be used.
- b. Two (2) pieces 1/2" (13 mm) schedule 40 steel pipe or stronger cut to suit installation, and threaded at both ends.

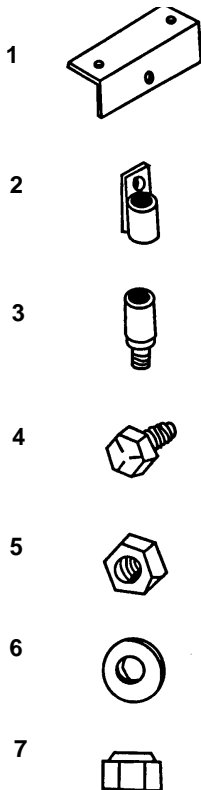

Item	Qty	Description
1	2	Angle Hanger
2	2	Connector Hanger
3	2	Adapter Hanger
4	2	1/2 UNC X 1-1/4 Grade 5 Bolt
5	2	1/2 UNC Self-locking Hex Nut
6	2	Washer
7	2	Lock Nut

Installation

Note: Dimensions are in inches (mm).

1. Fasten Angle Hangers (1) to surface or structure that will support the heater's weight.

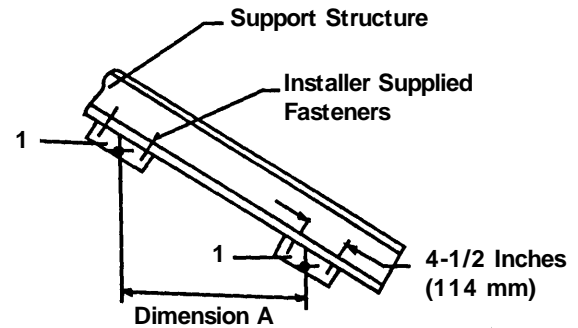

Dimension A = Distance between mounting holes.

**Cabinet No. 1 & 2 - 8 in.
Cabinet No. 3 15 - 1/2 in.
Cabinet No. 4 - 21-3/4 in.**

2. Screw one Connector Hanger (2) and one Adapter Hanger (1) onto each of the two steel pipes until tight (minimum of 5 turns each).

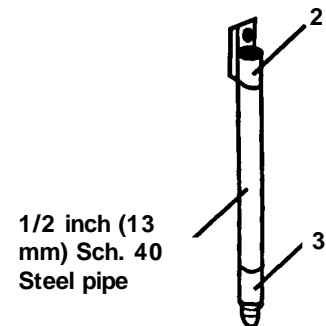

Pipe cut length = Distance from Support Structure to Top of heater Less 4-7/8" (124mm).

Installation Instructions

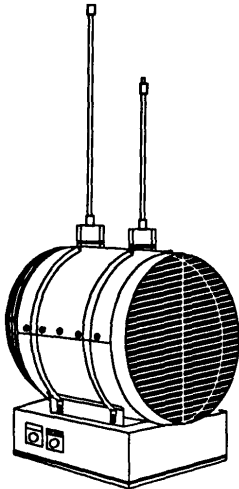

- 3. Screw Hanger Assemblies, from Step 2 into
- 4. Hang heater from Angle Hangers (1) using the two 1/2 UNC x 1 1/4 long bolts, and locking nuts.

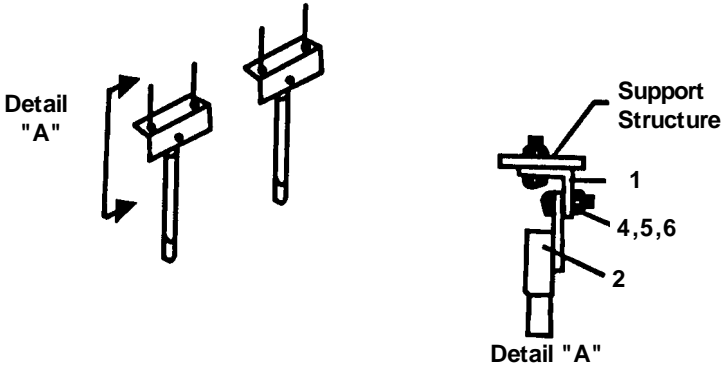

Notes: Connector (2) must be hung on the inside of Angle (1) as shown. Rotate Connector to align with angle. Do not back off more than 3/4 turns.