

INSTALLER'S GUIDE

18-GJ54D1-1A-EN

ALL phases of this installation must comply with NATIONAL, STATE AND LOCAL CODES

Front Return Kit:

BAYFRKIT175 For 17.5" Cabinet Air Handlers

BAYFRKIT210 For 21" Cabinet Air Handlers

BAYFRKIT235 For 23.5" Cabinet Air Handlers

Fits Models:

Hyperion™ and
ForeFront™
Air Handlers

IMPORTANT — This Document is customer property and is to remain with this unit. Please return to service information pack upon completion of work.

Section 1. Safety Information

⚠ WARNING

SAFETY HAZARD! This information is intended for use by individuals possessing adequate backgrounds of electrical and mechanical experience. Any attempt to repair a central air conditioning product may result in personal injury and/or property damage. The manufacturer or seller cannot be responsible for the interpretation of this information, nor can it assume any liability in connection with its use.

⚠ CAUTION

SAFETY HAZARD! Sharp Edge Hazard. Be careful of sharp edges on equipment or any cuts made on sheet metal while installing or servicing. Personal injury may result.

IMPORTANT: This kit is not recommended for sound sensitive applications. Before using this kit, blower and air sound levels should be considered.

NOTE: Illustrations are representative of typical installations. Individual air handler sizes and kits may vary.

Section 2. General Information

Open and inspect contents for damaged or missing items.

Each kit will contain:

- 1 - Bottom plate
- 1 - Filtered return assembly
- 1 - Gasket material
- 14 - 5/16 x 1/2" long screws
- 1 - Tube adhesive
- 1 - Filter
- 1 - Installer's guide

BAYFRKIT175 includes 16"x18" filter

BAYFRKIT210 includes 18"x20" filter

BAYFRKIT235 includes 18"x22" filter

⚠ CAUTION

SAFETY HAZARD!

Cutting and removal of air handler cabinet materials for the side return kit for Hyperion™ and ForeFront™ Air Handlers may result in debris being released into the air. PPE (Personal Protection Equipment) equipment for protection of the eyes, mouth, and nose is recommended for cutting and removal of air handler cabinet materials for the side return kit.

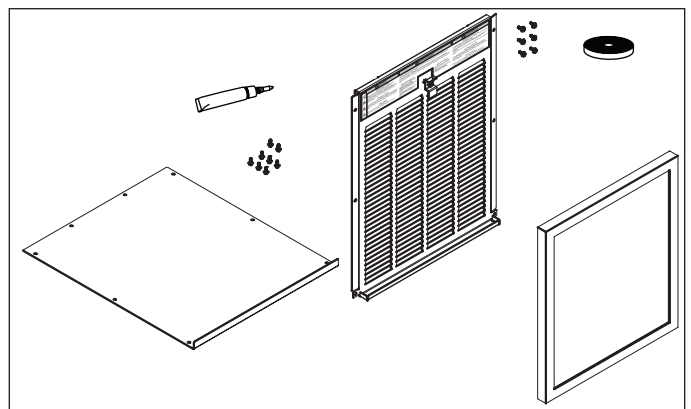
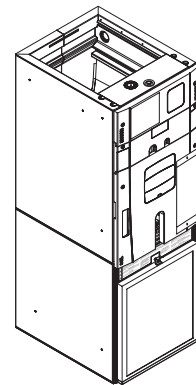

Section 3. Installation

Step 1 - Remove the Blower door panel from the air handler.

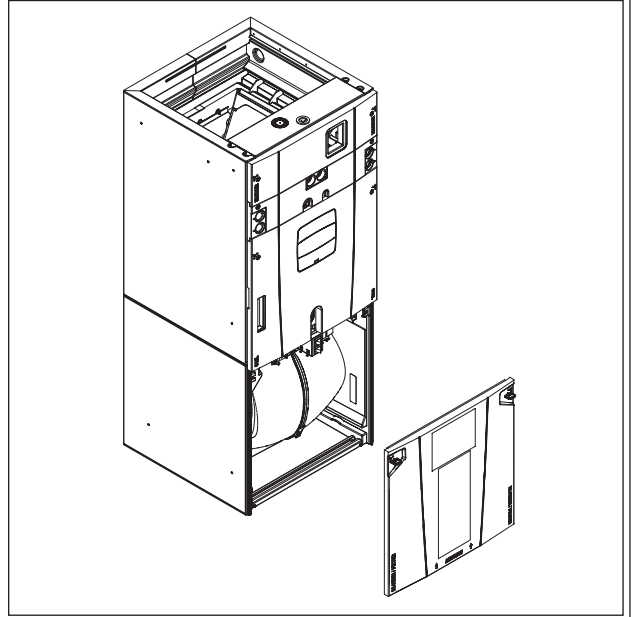

IMPORTANT: If the nameplate is required to remain on the unit, the nameplate section of the blower panel must be removed.

IMPORTANT: Once the cabinet door is cut, the front return kit must be used or the door replaced.

Step 2 - Use a reciprocating saw or jigsaw to cut out the nameplate from the front of the blower panel. The cut should be made along the sides of the nameplate.

Step 3 - Separate the front plastic piece with attached label from the foam and rear piece of plastic.

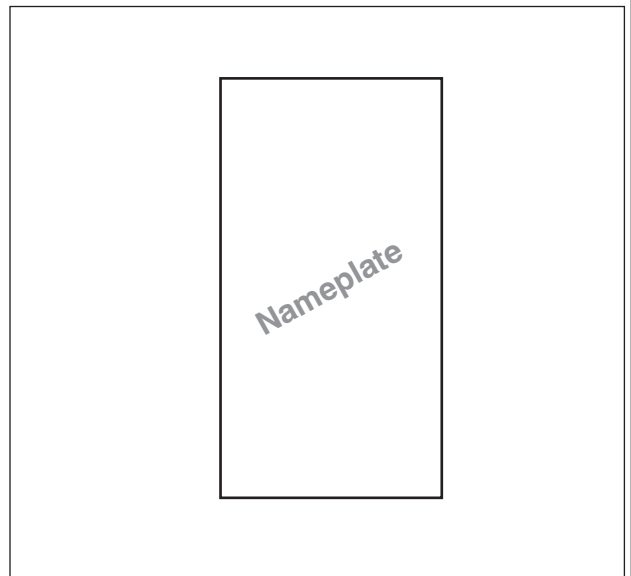

Step 4 - Apply adhesive to the back of the nameplate and stick the nameplate onto the right side of the coil panel making sure it does not block the coil panel mounting screw.

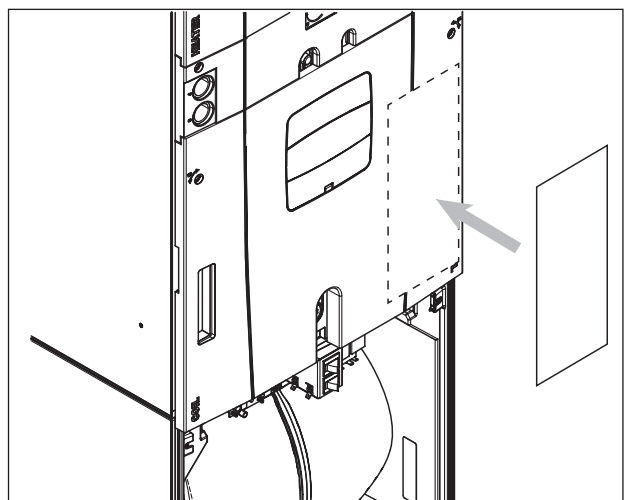

Step 5 - Apply gasket material onto three sides of the bottom panel as shown. The gasket should be applied along the outside edge of the bottom panel.

Apply the gasket material to the outside of the flange of the bottom panel.

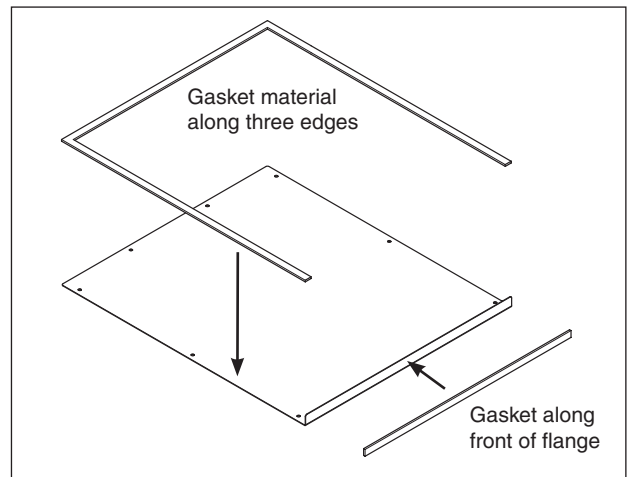

Step 6 - Apply the gasket material to the top of the flanges that run along the front of the louver panel as shown as shown.

Apply the gasket material along the two angled side flanges of the louver panel as shown. The side gasket pieces should run the length of each flange and be applied at the outer edge of the flange.

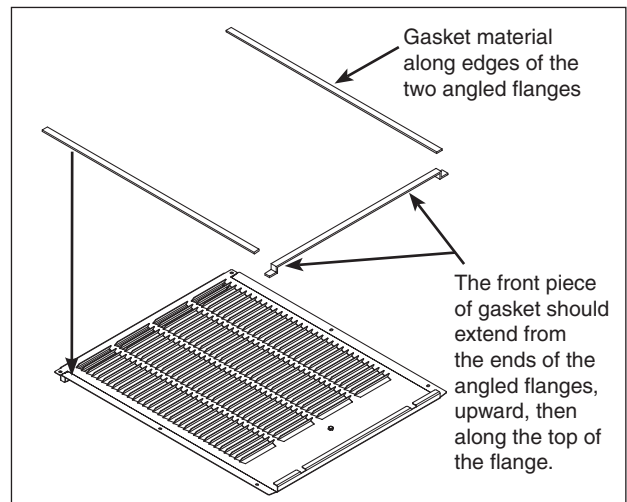

Step 7 - Turn the air handler upside down and use eight of the supplied screws to attach the bottom plate through the punched holes.

NOTE: Very little torque is required. A high torque setting may strip out the cabinet frame.

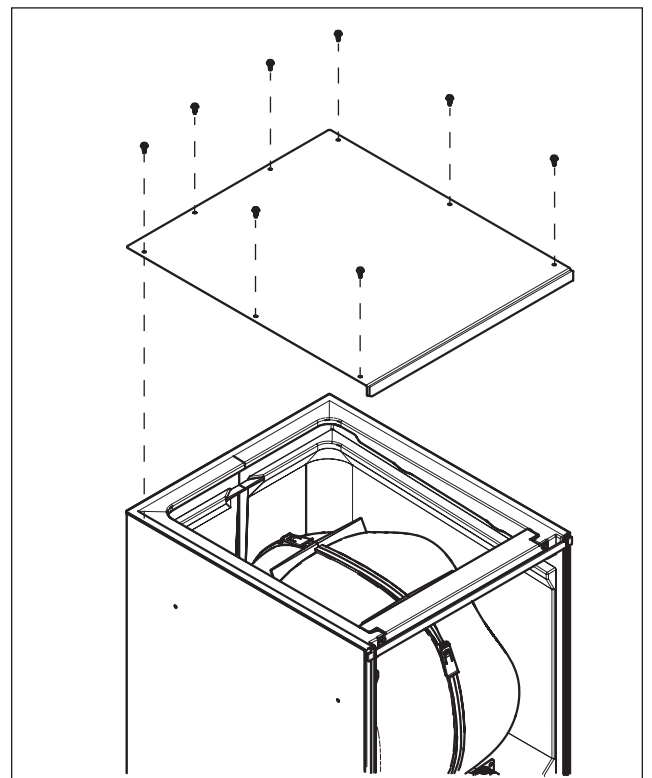

Step 8 - Attach the top of the front louver panel to the air handler cabinet. Use six self-tapping screws to attach the top of the louver panel to the cabinet.

NOTE: Very little torque is required. A high torque setting may strip out the cabinet frame.

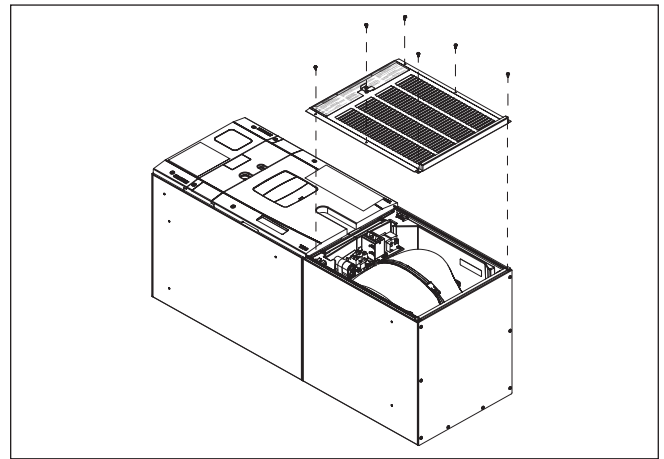

Step 9 - Set the filter in the bottom channel and rotate in place.

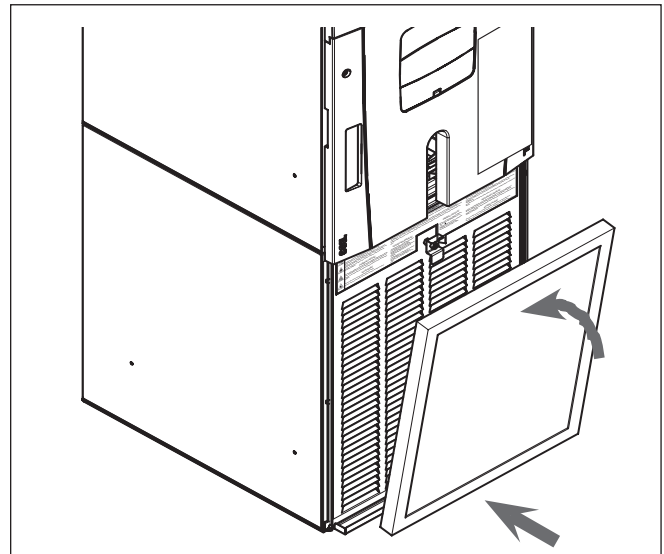

Step 10 - Secure the filter in place with the top clip. The clip rotates out of the way and then back in place to hold the filter.

Step 11 - Start the blower. Check for and seal any air leaks around the front grill.

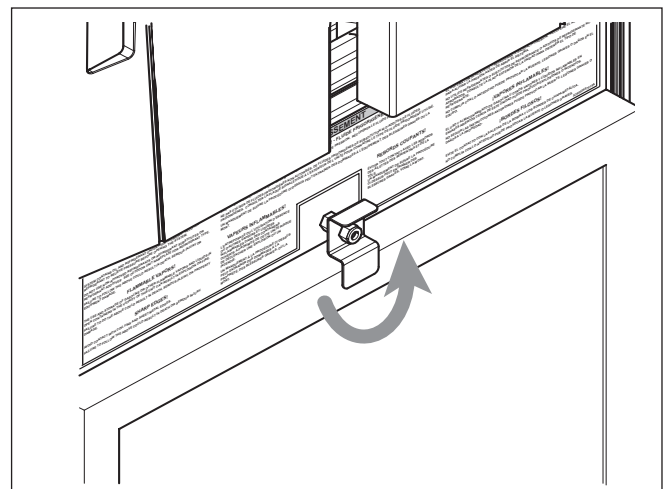

About Trane and American Standard Heating and Air Conditioning

Trane and American Standard create comfortable, energy efficient indoor environments for residential applications. For more information, please visit www.trane.com or www.americanstandardair.com

The manufacturer has a policy of continuous data improvement and it reserves the right to change design and specifications without notice. We are committed to using environmentally conscious print practices.

18-GJ54D1-1A-EN 31 Jul 2020

Supersedes 18-GJ54D1-1 (April 2012)

© 2020