

INSTALLER'S GUIDE

18-GJ46D1-3

ALL phases of this installation must comply with NATIONAL, STATE AND LOCAL CODES

Door Panel Fastener Kit for Air Leakage:

KIT18053

Fits Models:

Hyperion™ and
ForeFront™
Air Handlers

IMPORTANT—This Document is customer property and is to remain with this unit. Please return to service information pack upon completion of work.

Section 1. Safety Information

⚠ WARNING

SAFETY HAZARD! This information is intended for use by individuals possessing adequate backgrounds of electrical and mechanical experience. Any attempt to repair a central air conditioning product may result in personal injury and/or property damage. The manufacturer or seller cannot be responsible for the interpretation of this information, nor can it assume any liability in connection with its use.

⚠ WARNING

HAZARDOUS VOLTAGE! Disconnect all electrical power, including remote disconnects before servicing. Follow proper lockout/tagout procedures to ensure the power can not be inadvertently energized. Failure to disconnect power before servicing could result in property damage, serious personal injury or death.

⚠ CAUTION

SAFETY HAZARD! Sharp Edge Hazard. Be careful of sharp edges on equipment or any cuts made on sheet metal while installing or servicing. Personal injury may result.

Section 2. General Information

Open and inspect contents for damage or missing items.

Each kit will contain:

- 2 - 22 mm 1/4 turn fasteners
(for installed units only)
- 6 - #12 x 11 x 1-1/4" screws
- 6 - Machine thread receptacles
- 10 - Rubber retainers
- 1 - Installer's Guide

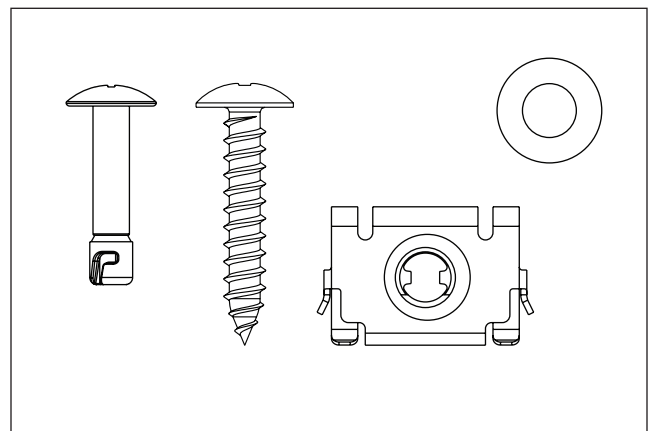

Section 3. Installation

WARNING

HAZARDOUS VOLTAGE! Disconnect all electrical power, including remote disconnects before servicing. Follow proper lockout/tagout procedures to ensure the power can not be inadvertently energized. Failure to disconnect power before servicing could result in property damage, serious personal injury or death.

IMPORTANT — Instructions shown are for installed air handlers. If your air handler has not been installed and the evaporator coil lines have not been brazed, remove the lineset panel and follow the same procedures used on the other two panels.

IMPORTANT — If the air handler is installed and the evaporator coil is brazed in place, the lineset panel may not be able to be removed completely. Remove the existing $\frac{1}{4}$ turn fasteners on the lineset panel and install the shorter $\frac{1}{4}$ turn fasteners shipped with the kit. Follow instructions on removing the retainers and adding the rubber retainer as shown on the other panels.

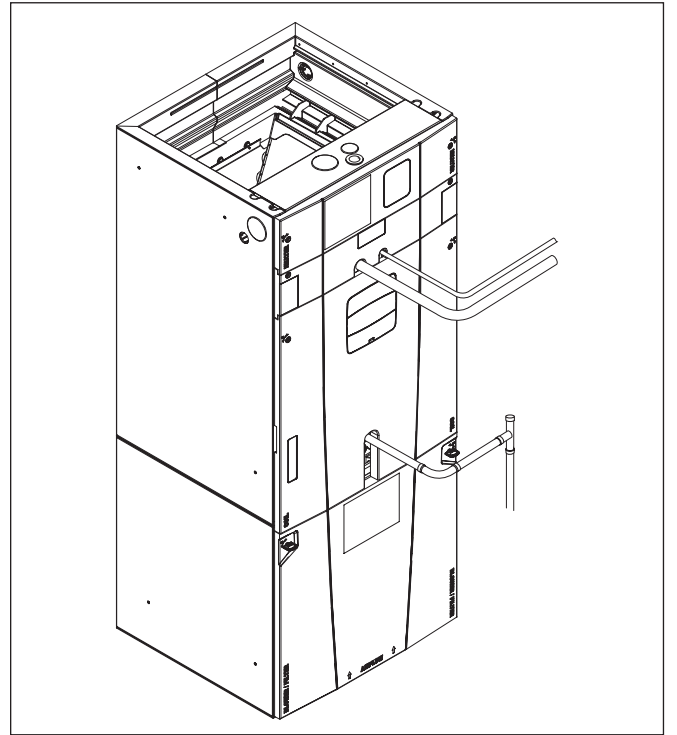

Step 1 - Remove heater and coil panels and place on a surface that will not scratch the panels.

Step 2 - Remove the rubber gasket along the two sides of the coil compartment.

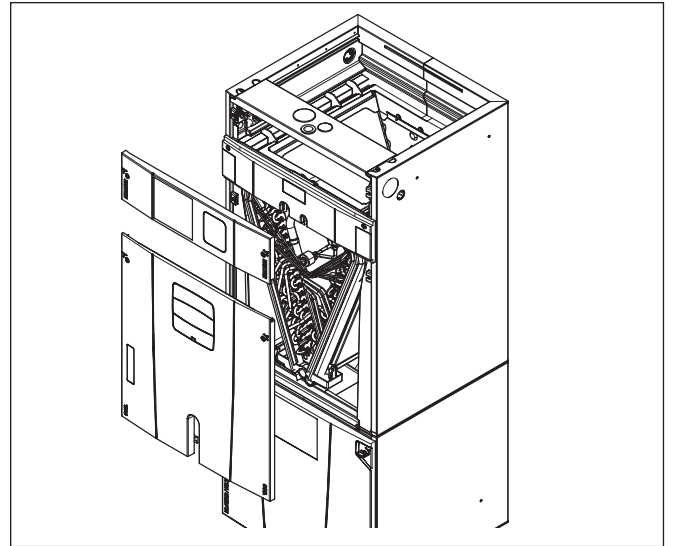
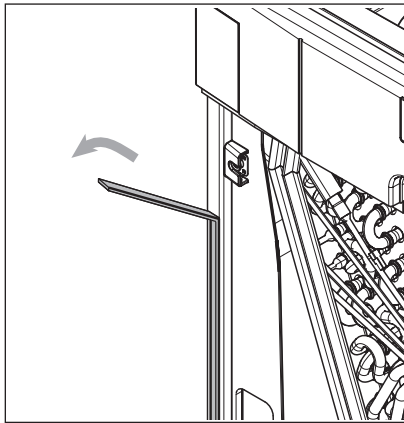

Step 3 - Remove the $\frac{1}{4}$ turn receptacles from the cabinet receptacles holders. There will be two receptacles per panel.

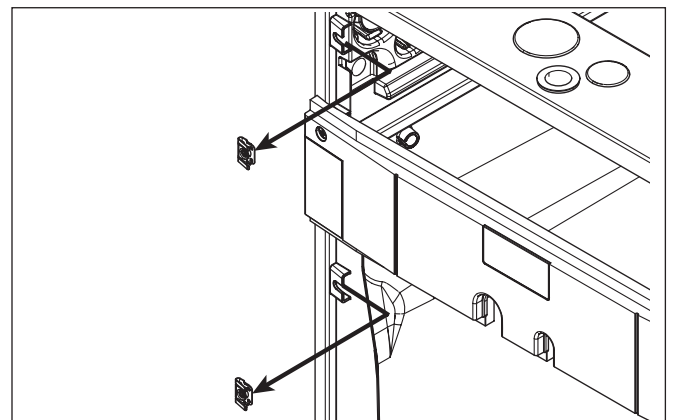

Step 4 - Install new receptacles making sure they are fully seated in the cabinet receptacle holder. The flat side of the receptacle should be against the cabinet and the bent edge should go first into the receptacle holder. Install two receptacles per panel.

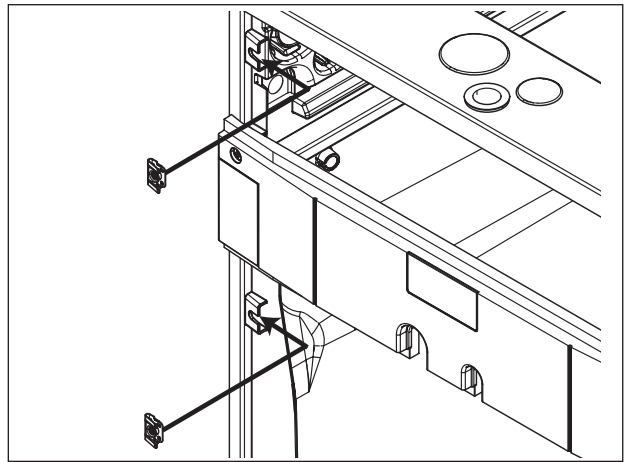
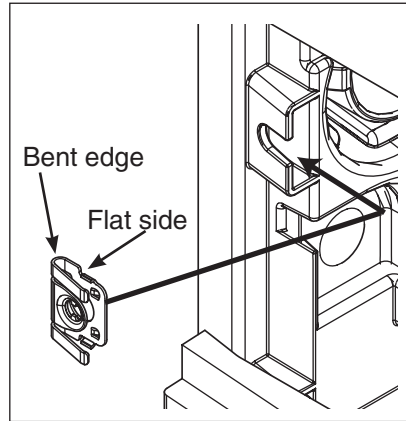

Step 5 - Drill a pilot hole into the cabinet wall using up to a 5/32" drill bit using the receptacle as a guide. Repeat this for each of the newly installed receptacles.

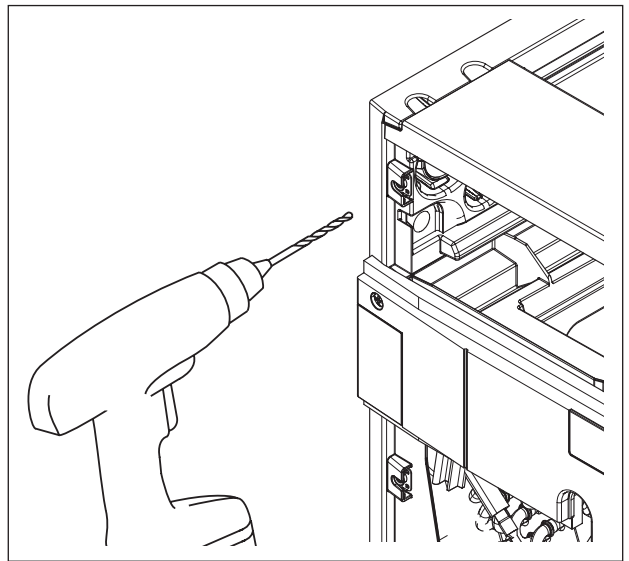

Step 6 - If the air handler is not installed and the evaporator coil lines have not been brazed, go to Step 7.

If the air handler is installed and evaporator coil brazed in place, remove the existing 1/4 turn fasteners and retainers on the lineset panel and install the shorter 1/4 turn fasteners and rubber retainers shipped with the kit.

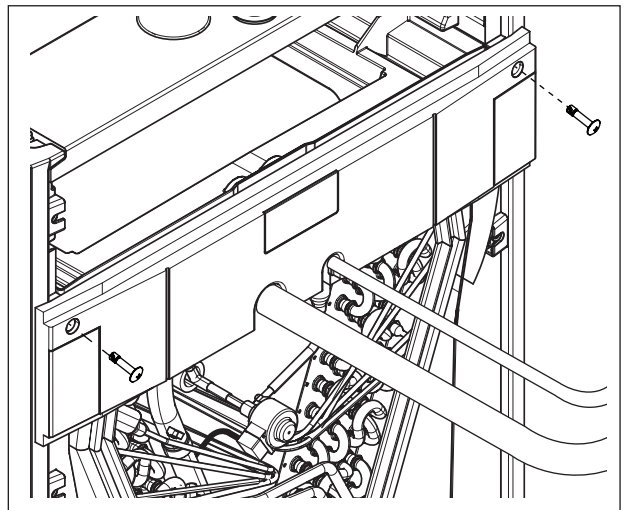

INSTALLER'S GUIDE

Step 7 - Remove existing retainer rings on ¼ turn fasteners. Remove ¼ turn fasteners. Repeat for all of the fasteners on the removed panels.

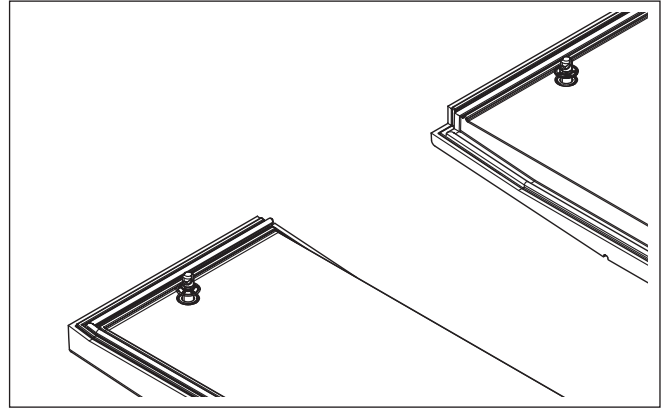

Step 8 - Insert new screw through the panel and secure with new rubber retainer. Repeat for all of the panels.

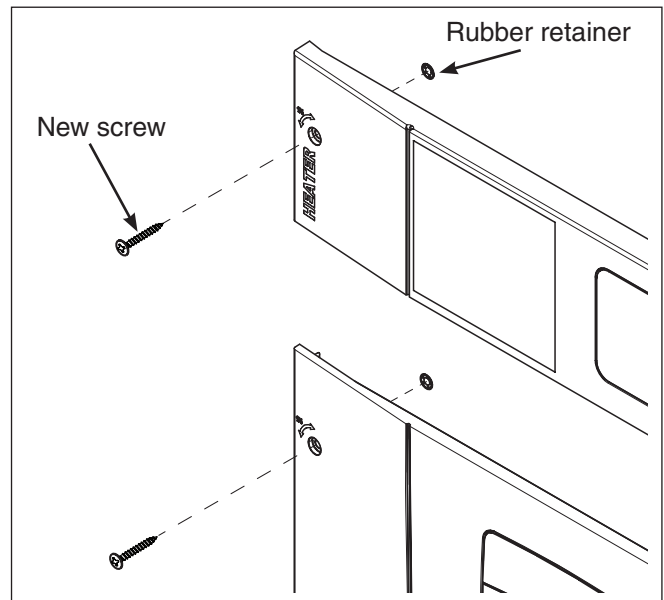

Step 9 - Install new panels and securely tighten. DO NOT use a cordless driver that is set to the "drill" setting. Use a low-range torque setting for optimal results (13 in-lb).

