

INSTALLER'S GUIDE

18-GJ13D1-3A-EN

ALL phases of this installation must comply with
NATIONAL, STATE AND LOCAL CODES

Side Return Kit:

BAYSRKIT100A for 1-1/2 - 5 Ton
Air Handler Installations

Fits Models:

Hyperion™ and
ForeFront™
Air Handlers

IMPORTANT— This Document is customer property and is to remain with this unit. Please return to service information pack upon completion of work.

Section 1. Safety Information

⚠ WARNING

SAFETY HAZARD! This information is intended for use by individuals possessing adequate backgrounds of electrical and mechanical experience. Any attempt to repair a central air conditioning product may result in personal injury and/or property damage. The manufacturer or seller cannot be responsible for the interpretation of this information, nor can it assume any liability in connection with its use.

⚠ WARNING

SAFETY HAZARD! Sharp Edge Hazard. Be careful of sharp edges on equipment or any cuts made on sheet metal while installing or servicing. Personal injury may result.

⚠ WARNING

LIVE ELECTRICAL COMPONENTS! During installation, testing, servicing, and troubleshooting of this product, it may be necessary to work with live electrical components. Failure to follow all electrical safety precautions when exposed to live electrical components could result in death or serious injury.

⚠ CAUTION

SAFETY HAZARD!

Cutting and removal of air handler cabinet materials for the side return kit for Hyperion™ and ForeFront™ Air Handlers may result in debris being released into the air. PPE (Personal Protection Equipment) equipment for protection of the eyes, mouth, and nose is recommended for cutting and removal of air handler cabinet materials for the side return kit.

Section 2. General Information

Open and inspect contents for damage or missing items.

Each kit will contain:

Item	Qty	Description
1	1	Plate Assembly
2	1	Template
3	2	Long Flange
4	2	Short Flange
5	8	10-32 Serrated Nut
6	1	Bottom Return Block-off Plate
7	1	Double Sided Foam Tape
8	1	Installer's Guide

The inside duct opening for the side return kit is:
11 inches tall
15.5 inches deep

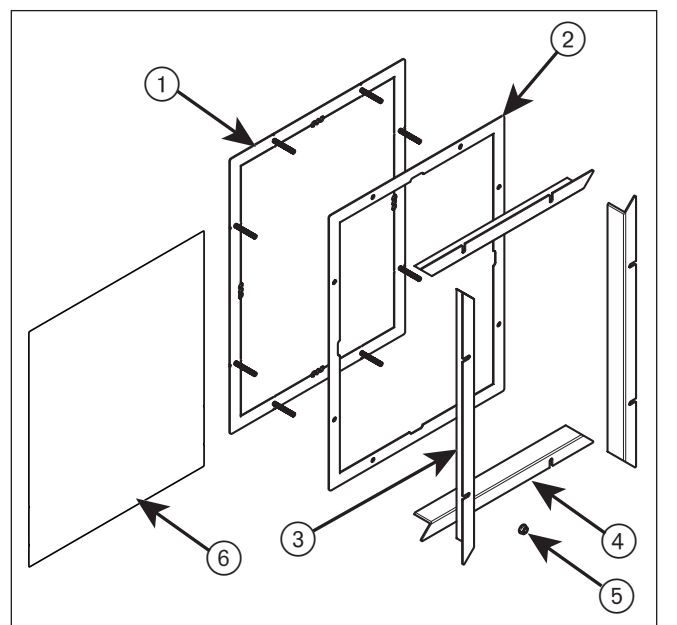

Section 3. Applications

Important: Air handlers above 1200 CFM will require two side return kits or one side return kit with a bottom return.

Important: Due to the unique design of this unit, which allows the electrical wiring to be routed within the insulation, do not screw, cut, or otherwise puncture the unit cabinet above the blower section.

Note: Application drawings are for reference only.

Note: Additional transition length and plenum height will reduce air turbulence and velocity.

Air Handlers up to 1200 cfm

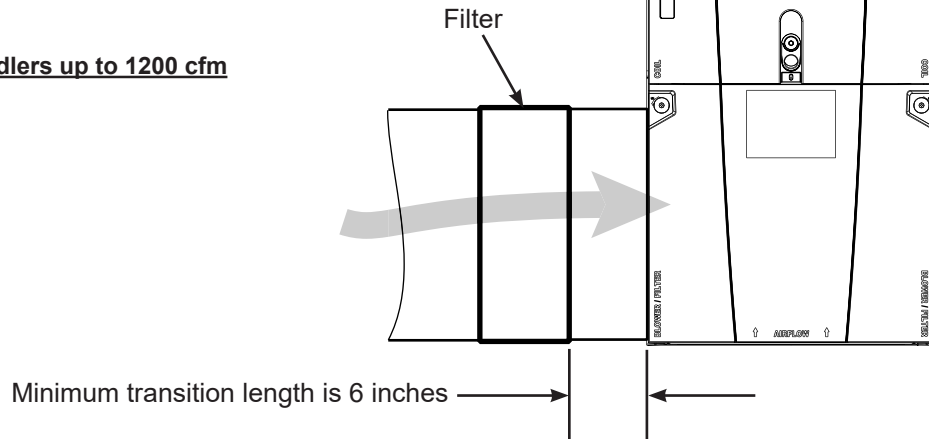

Air Handlers over 1200 cfm

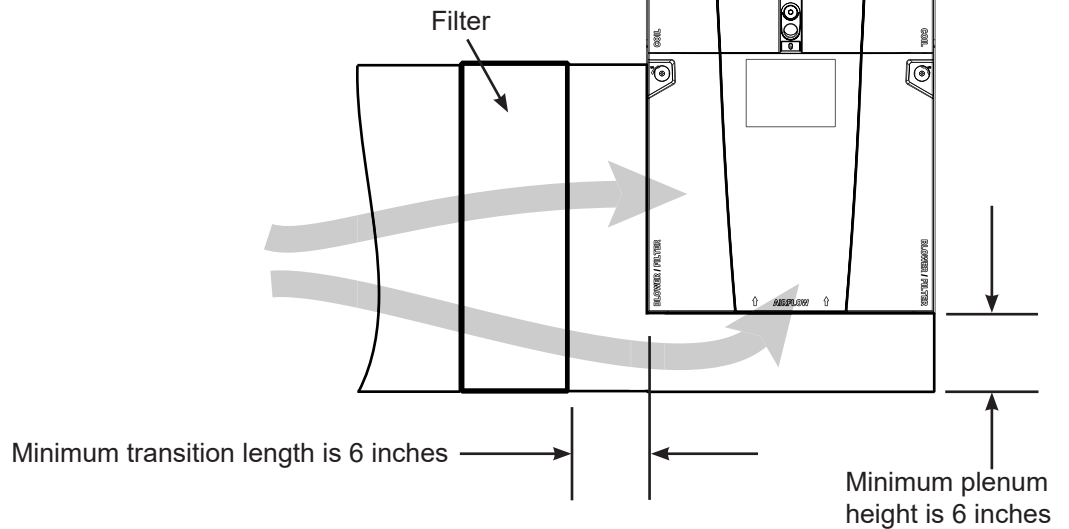

Section 4. Installation

Note: The side return kit should be installed before installing the air handler.

STEP 1 - Set the air handler in an open environment that provides plenty of room to install the kit.

STEP 2 - Evaluate the install application and determine which side of the air handler the return duct will enter. Make a mark on the side of the blower to identify this.

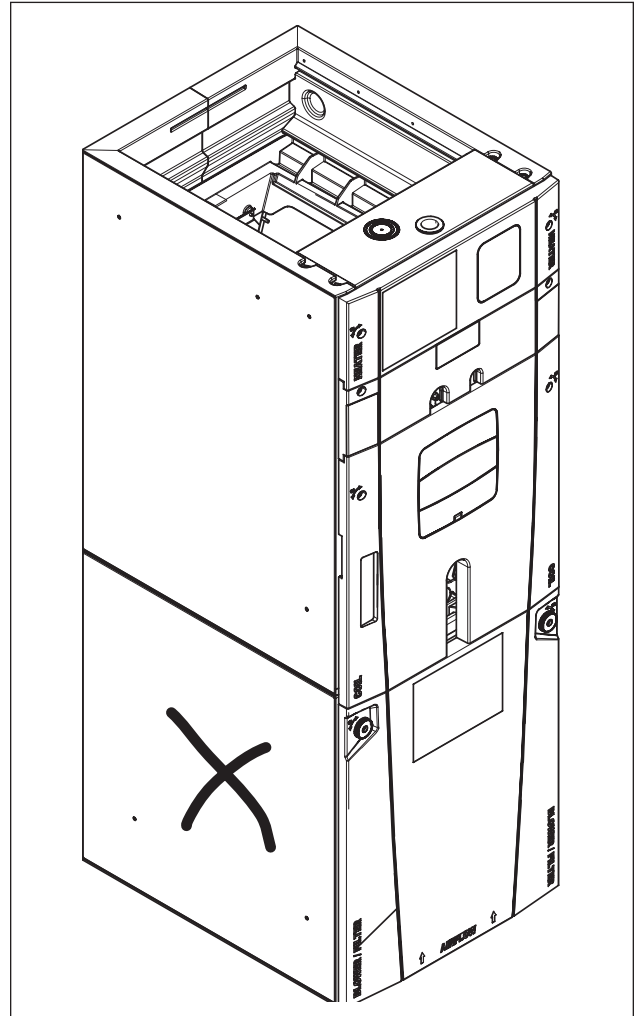

STEP 3 - Remove blower panel once the proper side is noted.

The Blower/Filter panel is removed using thumb screws.

1. Turn thumb screws on Blower/Filter panel.
2. Pull top of panel out, away from cabinet.
3. Lift panel up out of channel.
4. Set aside.

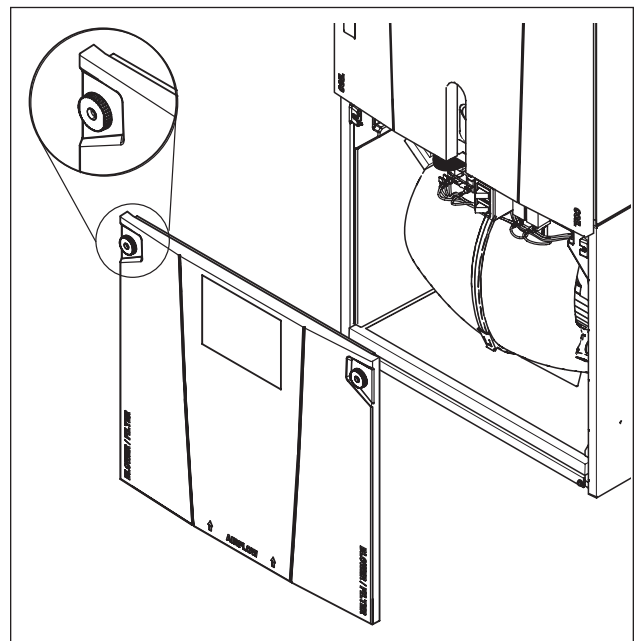

STEP 4 - Remove the blower by first disconnecting the two wiring connections routed to the blower assembly.

STEP 5 - Slide Blower assembly out of unit using built-in blower support channels and set aside.

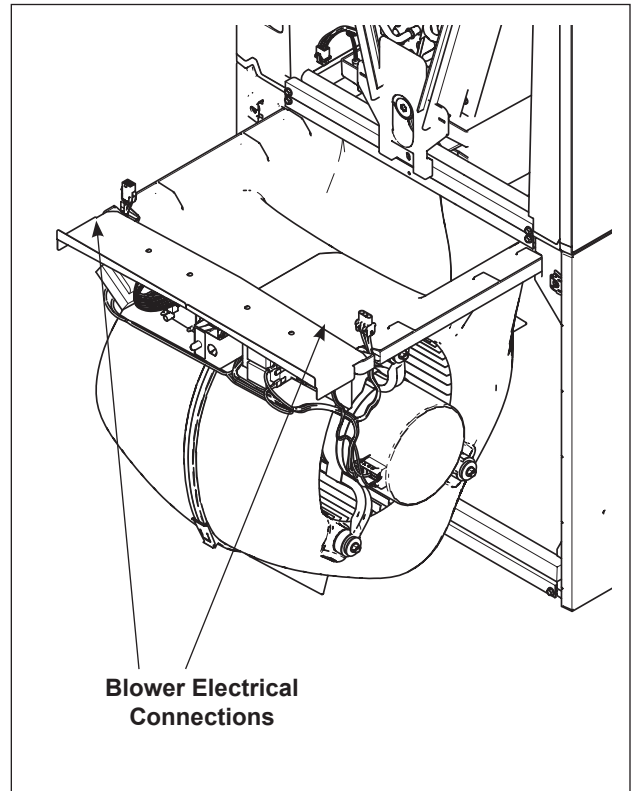

For one piece cabinet models GAF2, skip to STEP 7.

STEP 6 - Find a location where the air handler can be placed on its side without scratching or damaging the cabinet. Set the template on the side of the blower panel. The inside of the template must be 4-3/4" from the bottom and 3-3/4" from the back of the air handler.

The template must be square. Use a marker if needed to outline measurements.

For duct dimensions, refer to the figure on page 5.

Go to STEP 8.

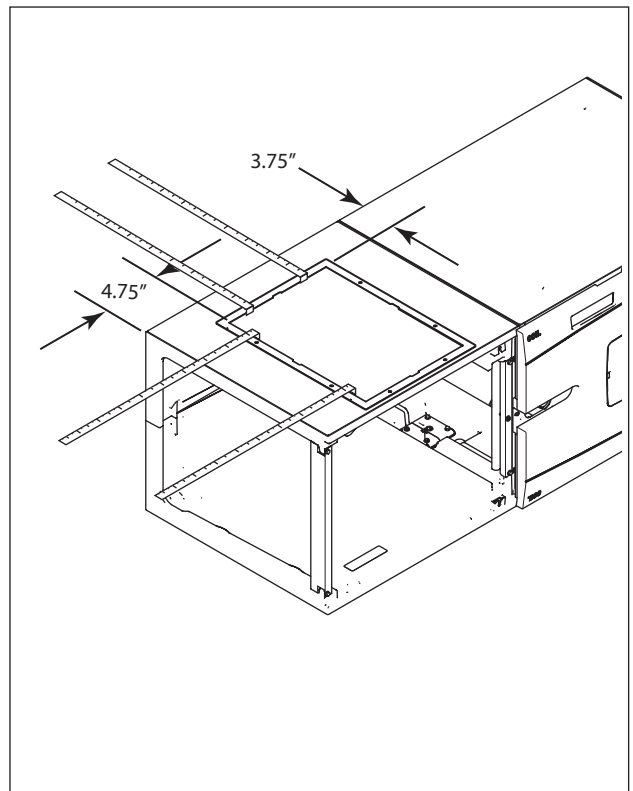

One piece cabinet models GAF2

STEP 7 - Find a location where the air handler can be placed on its side without scratching or damaging the cabinet. Set the template on the side of the blower panel. The inside of the template must be 2-3/4" from the bottom and 3-3/4" from the back of the air handler.

The template must be square. Use a marker if needed to outline measurements.

For duct dimensions, refer to the figure below.

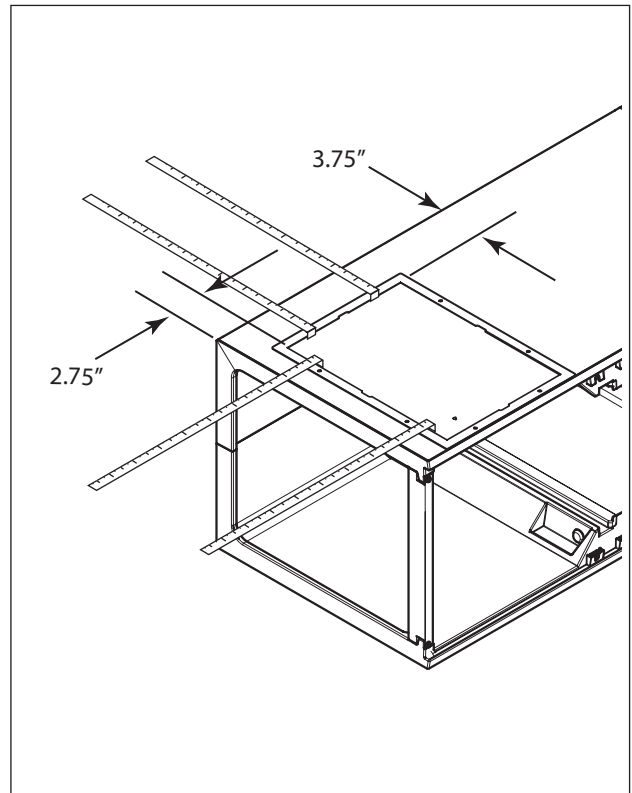

Side Return Opening - The inside dimension of the side return opening will be 11.0" x 15.5". If used, add 0.75" for the supplied flange.

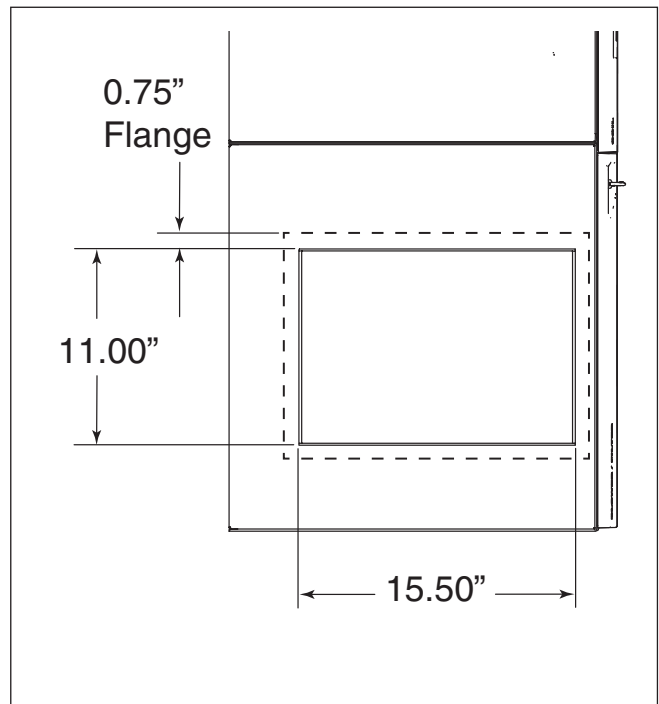

STEP 8 - Use a felt pen to mark the 8 holes in the template.

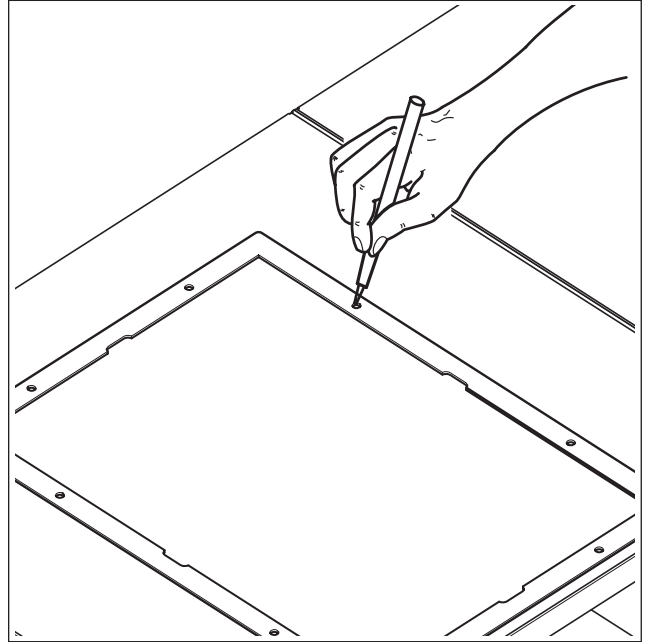

STEP 9 - Use a 1/4 inch bit to drill each of the 8 points. The drill must be perpendicular to the air handler. The plate assembly will not fit through the holes if they are drilled in at an angle.

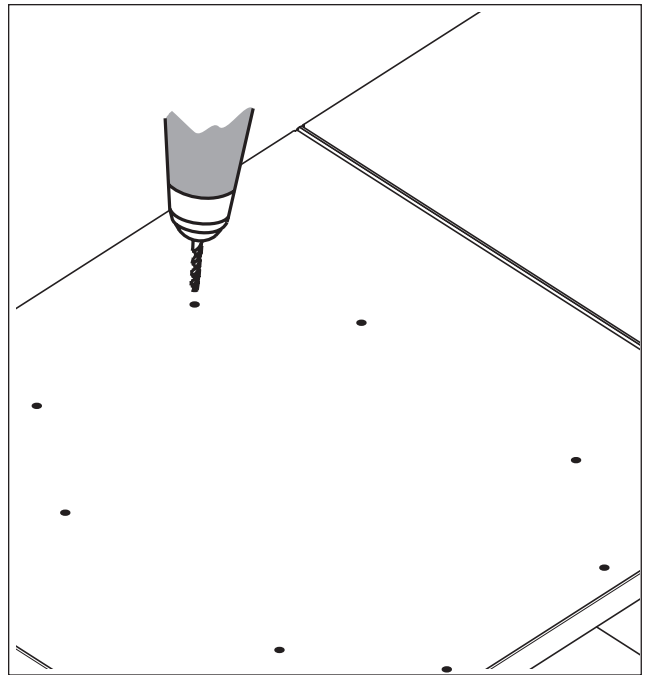

STEP 10 - Set the plate assembly with the 8 studs on the outer side of the cabinet so the bolts penetrate through the cabinet.

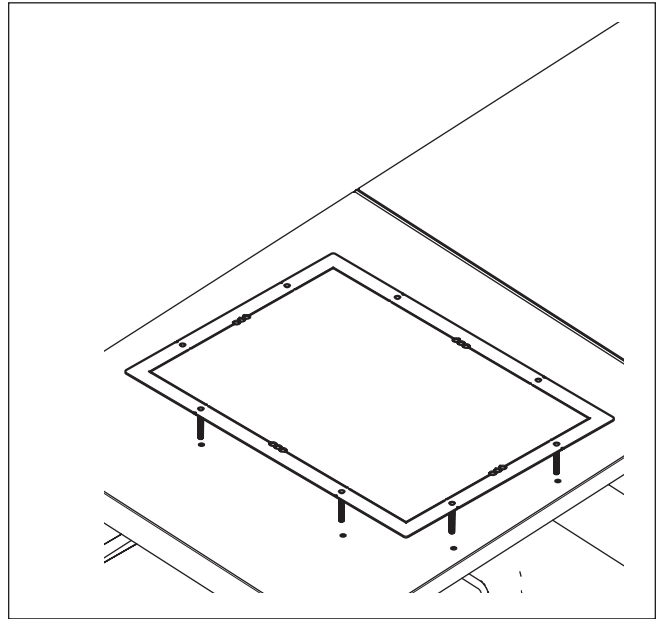

STEP 11 - Place the template over the studs and secure with the nuts provided.

Important: *The plate assembly and template must be tight and secure to provide a clean cut through the cabinet.*

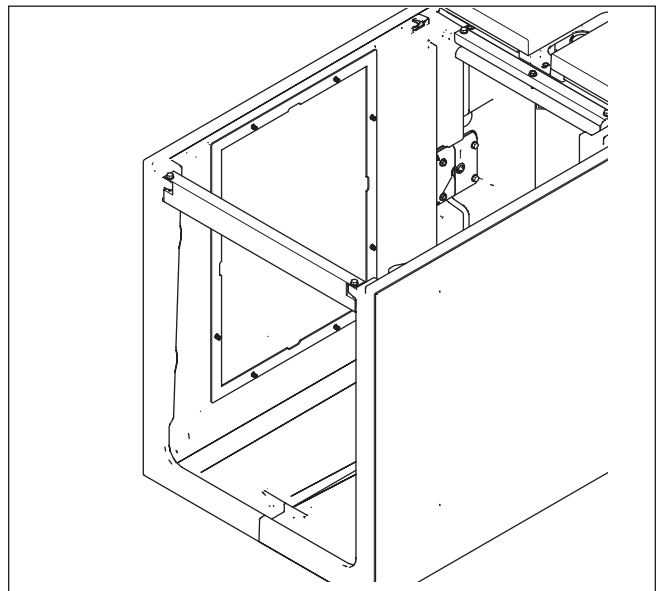

STEP 12 - Drill out the three holes located on each side of the template

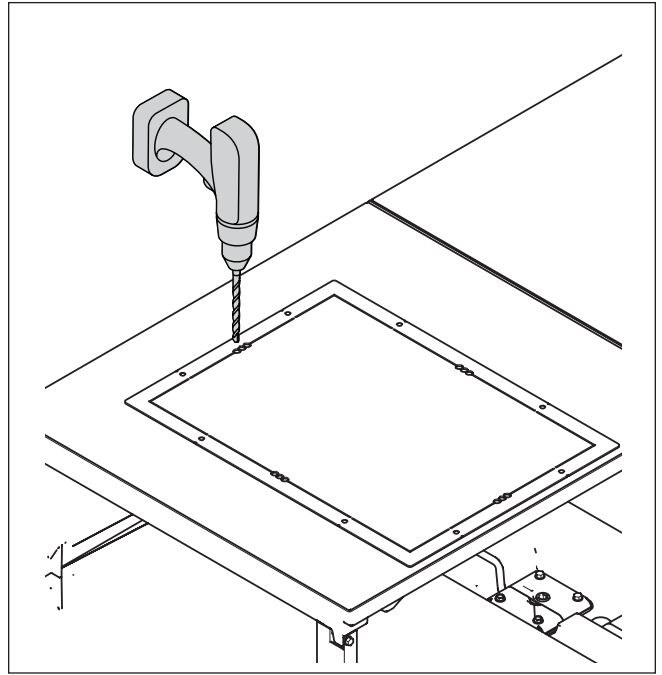

STEP 13 - Starting at the pilot holes, use a reciprocating saw and cut out template.

Caution: Evaluate the hole and remove any sharp edges or burrs generated by the saw blade.

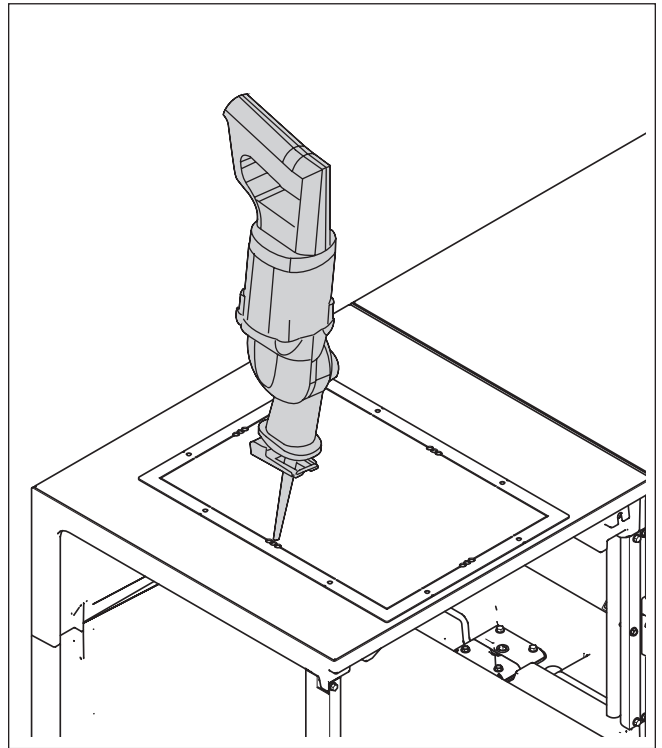

STEP 14 - Loosen the nuts and set the four flanges in place to cover the inner cabinet insulation.

Tighten the nuts two full turns past finger tight.

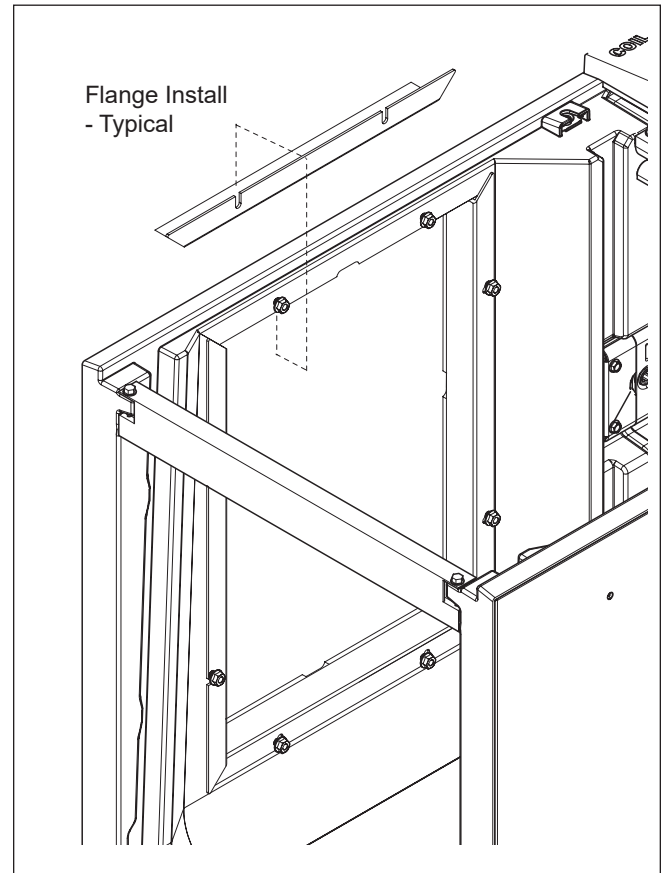

Section 5. Bottom Return Block-off Plate Installation

Note: The bottom return block-off plate may be used to seal the base of the air handler for side return only applications.

Important: Air handlers above 1200 CFM will require two side return kits or one side return kit with a bottom return.

STEP 1 - Cut the bottom block off plate to the appropriate size for A and B cabinets. No change is needed for the C size cabinet (23.5").

Cabinet Size	Plate Height	Plate Width
A	20.2	17.5
B	20.2	21.3
C	20.2	23.5

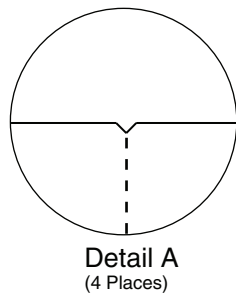

Detail A
(4 Places)

C
Cabinet
(no cut required)

Detail A

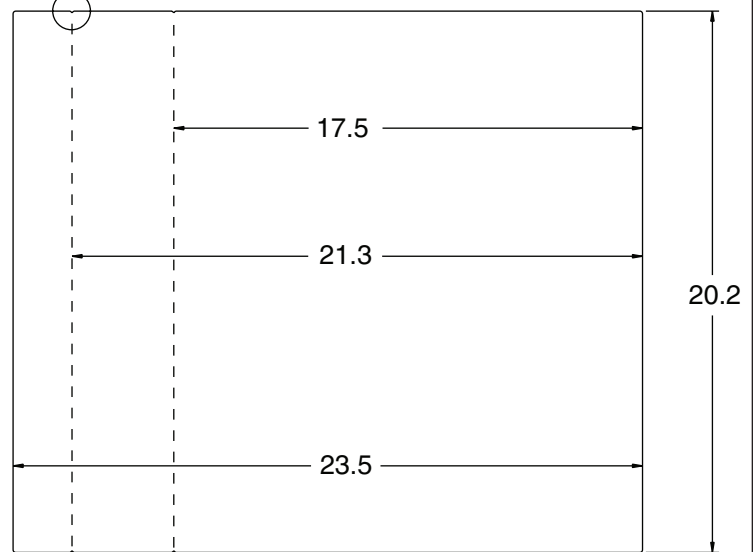

C
Cabinet

B
Cabinet

A
Cabinet

STEP 2 - Wipe the block-off plate to remove any debris.

STEP 3 - Cut the double-sided foam tape to fit the plate. The tape must be flush to the outer edge of the block-off plate.

STEP 4 - Wipe the bottom of the air handler to ensure it is clean.

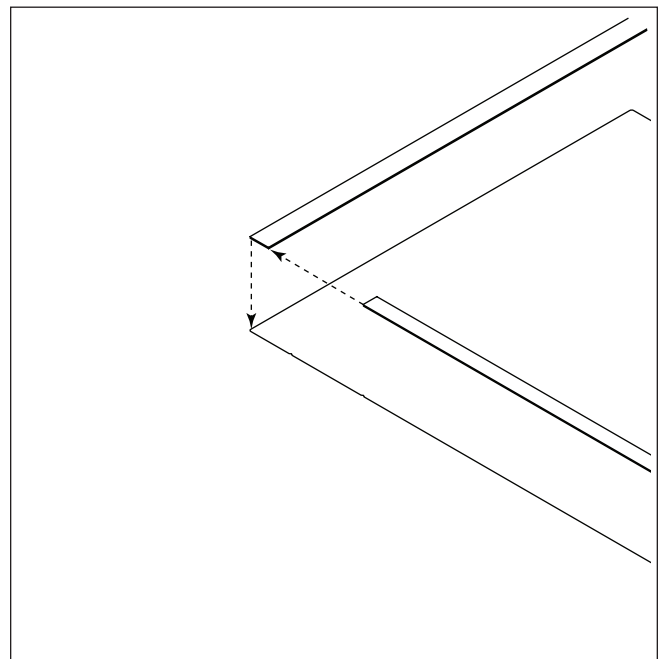

STEP 5 - Attach the plate to the bottom of the air handler. Press firmly to make sure the double-sided tape adheres to the air handler.

STEP 6 -Place the air handler in the installation location and attach return duct to the air handler cabinet. Secure and seal the duct work to the air handler per local codes.

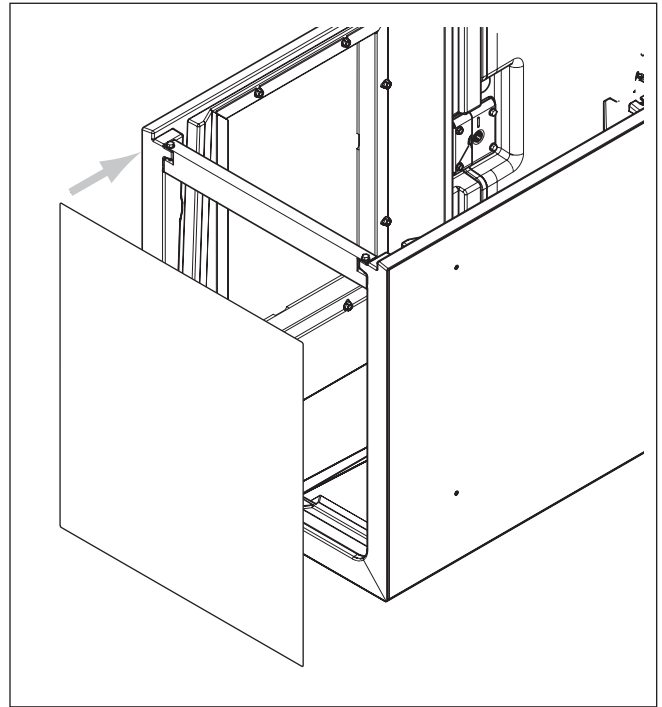

About Trane and American Standard Heating and Air Conditioning

Trane and American Standard create comfortable, energy efficient indoor environments for residential applications. For more information, please visit www.trane.com or www.americanstandardair.com

The manufacturer has a policy of continuous data improvement and it reserves the right to change design and specifications without notice. We are committed to using environmentally conscious print practices.

18-GJ13D1-3A-EN 04 Aug 2020

Supersedes 18-GJ13D1-3 (January 2001)

© 2020