

INSTALLER'S GUIDE

18-AH14D10-2A-EN

ALL phases of this installation must comply with NATIONAL, STATE AND LOCAL CODES

Model:
KIT06654
KIT06655
KIT06656

Comfort Coil™ Door Kit

IMPORTANT— This Document is customer property and is to remain with this unit. Please return to service information pack upon completion of work.

A. GENERAL

⚠ WARNING

These instructions should be used only by qualified individuals. These individuals should be specifically trained and experienced in the installation of furnaces, related accessories, and comfort conditioning components. Improper installation can create a hazard which could result in property damage, personal injury, or death.

These instructions do not cover all variations in systems or provide for every possible contingency. Further information may be desired or particular problems arise which are not covered sufficiently by these instructions. Contact your local distributor or the manufacturer as listed on the furnace nameplate.

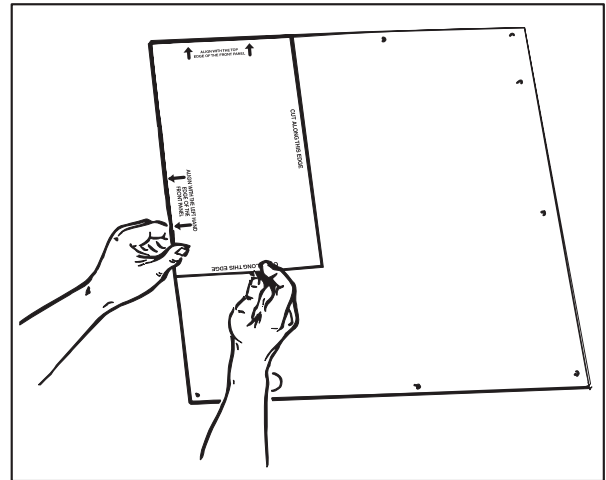

Figure 1

APPLICATION TABLE		
MODEL	CASE HEIGHT	MODELS USED ON
KIT06654	17.5	TXC018,24,25,31-C-A,B CCB18,24,30,36-A-A,B,C
KIT06655	22.5	TXC030,035,036,037,042,043-C-A,B TXC031-E/S-A,B CCB36,42,48-A-A,B,C
KIT06656	30.0	TXC048,049,050,060,061-C-A,B TXC036,037,054,065-E/S-A,B CCB60-A-A,B,C

B. INSPECTION

Check carefully for any shipping damage. This must be reported to and claims made against the transportation company immediately. Check to be sure all major components are in the container. Any missing parts should be reported to your supplier at once, and replaced with authorized parts only.

Parts List:

Item	Description	Qty.
1	Front Panel Section	1
2	Drill Screws	8
3	Grommets.	3
4	Template (KIT06656 requires 2 templates)	1 or 2

C. INSTALLATION

The kits allow for retrofit of an updated coil into an older coil case. The updated coil has three tubing extensions from the front panel of the coil case. Parts List:

1. Place the front panel of the coil case on a flat surface.
2. Align the template to the upper left corner of the front panel. See Figure 1.
3. Peel the backing from the template material and stick the template to the panel as aligned in Step #2.

NOTE: There are two templates for the KIT06656. The second template (B) is aligned to the line on the bottom of the first template (A) and attached as previously stated.

4. Place the new panel section on top of the template.
5. Mark the screw holes on the coil front panel and then place the new panel to the side.
6. Drill a pilot hole for each of the marked screw holes.
7. Cut along the edge of the template as marked with metal shears (aviation snips).

INSTALLER'S GUIDE

8. Attach the new panel section to the front panel with the included drill screws using care to seal the seams.
9. Insert the coil and attach the front panel before brazing the tubing.

NOTE: Use care when installing the coil and front panel. Be sure that no copper tubing is in contact with the foil insulation, screws, etc.

About Trane and American Standard Heating and Air Conditioning

Trane and American Standard create comfortable, energy efficient indoor environments for residential applications. For more information, please visit www.trane.com or www.americanstandardair.com

The manufacturer has a policy of continuous data improvement and it reserves the right to change design and specifications without notice. We are committed to using environmentally conscious print practices.