

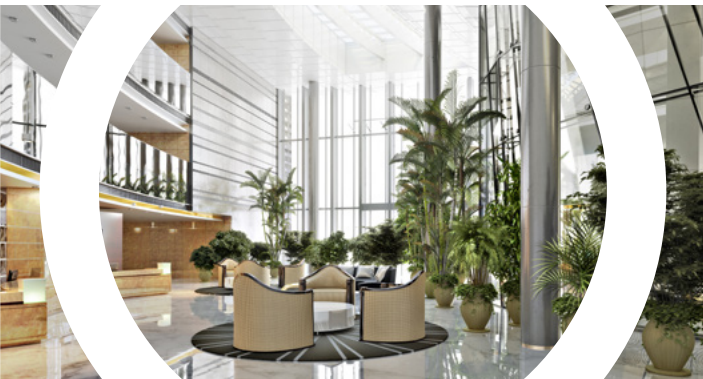

TRANE®



HVAC Guide™

Guided probe tester



Features

- Easy to use INPUT/OUTPUT forms to collect and analyze data.
- Use Fieldpiece accessory heads to automatically enter data.
- Manually enter data using non-Fieldpiece test equipment.
- Download test data to a PC.
- Reload test data when returning to the same customer.
- Easily print work orders for better customer service.

Benefits

- Minimize call-backs.
- Easier analysis.
- Faster testing.
- Higher quality job.
- Wider range of tests with less backup a
- More effective HVAC installation and maintenance.
- Download tests to a PC.
- Keep a track of all customer records.

HVAC  GUIDE™
GUIDED PROBE TESTER



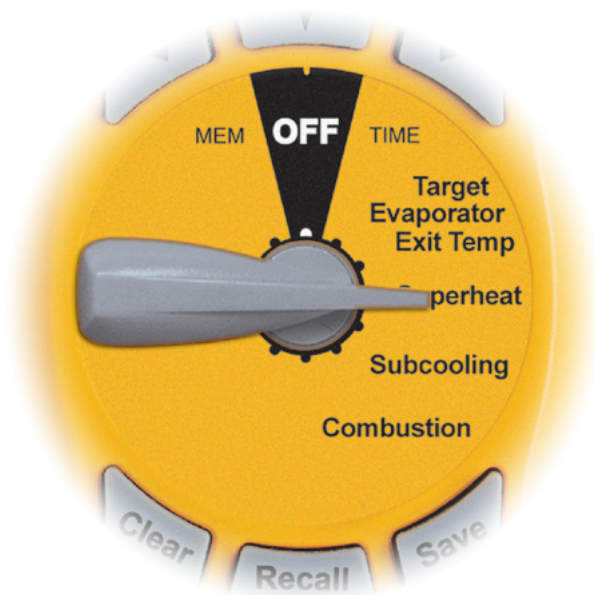

Upload test data to PC via USB. Delete test data or customer file from **memory**.

Set real-**time** clock.

Determine actual and **target evaporator exit temperature** by taking three temperature measurements.

Determine target and actual **superheat** from indoor wet bulb, outdoor dry bulb, suction line temperature, and suction line pressure.

Determine actual **subcooling** from liquid line temperature and pressure and compare to target subcooling.

Analyze the **combustion** process from flue temperature, %O₂, CO ppm, and primary temperature.



- Superheat
- Subcooling
- Target evap
- Exit temp
- Combustion analysis
- All-in-one!

Part # TOLO3085 (HG1)

1. Enter data on the INPUT FORM.

```
INPUT FORM
SH Table:Standard
Refrigerant:R-22
OD Dry Bulb:      95.8°F
ID Wet Bulb:      71.3°F
SL Pressure:     64.2psig
SL Temp:         41.0°F
Customer ID: JONES123
```

2. Press the Output button.



3. Read the results from the OUTPUT FORM.

```
OUTPUT FORM
Target SH:      19.9°F
Actual SH:      04.0°F
Boiling Point:  37.0°F
See Sec:2.1, 2.2, 2.3
```

What's included



- ATH4 dual temp head
- Wet bulb thermocouple
- Dry bulb thermocouple
- Padded case
- USB cable
- PC software



Trane – by Trane Technologies (NYSE: TT), a global climate innovator – creates comfortable, energy efficient indoor environments through a broad portfolio of heating, ventilating and air conditioning systems and controls, services, parts and supply. For more information, please visit trane.com or tranetechnologies.com.

*All trademarks referenced in this document
are the trademarks of their respective owners.*

© 2020 Trane. All Rights Reserved.

RSP-SLB148-EN

07/06/2020