

Installer's Guide

18-CH104D1-1C-EN



Sound Attenuation Panel BAYQT*PU1 and BAYQT*UU1

ALL phases of this installation must comply with NATIONAL, STATE AND LOCAL CODES

IMPORTANT—This Document is customer property and is to remain with this unit. Please return to service information pack upon completion of work.

GENERAL

This accessory is to be used with S8/A8 furnaces in upflow applications only, including all venting options. Verify the cabinet width of the furnace matches the 6th digit of the BAYQT* accessory.

A = 14.5", B = 17.5", C = 21.0"

⚠ WARNING

HAZARDOUS VOLTAGE!

Disconnect all electrical power, including remote disconnects before installing or servicing. Follow proper lockout/tagout procedures to ensure the power can not be inadvertently energized. Failure to disconnect power before servicing could result in death or serious injury.

⚠ WARNING

SAFETY HAZARD!

This kit must be installed by a qualified technician possessing adequate backgrounds of electrical and mechanical experience. Failure to follow this warning may result in personal injury, property damage, or death.

⚠ WARNING

This product can expose you to chemicals, including lead, which are known to the State of California to cause cancer and birth defects of other reproductive harm. For more information go to www.p65Warnings.ca.gov.

Only install this kit in equipment that meets the airflow clearance requirements as listed below:

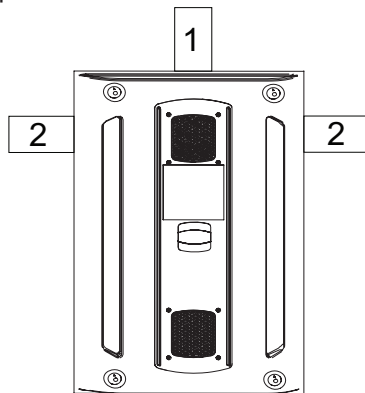

| Item | Vent Direction | Cabinet A | Cabinet B | Cabinet C |
|------|----------------------|---|--|-----------|
| 1 | Top - Vent | 1" on both sides only | 1" on both sides or 2" on one side and zero on other | |
| 2 | Right or Left - Vent | 1" opposite side & 1" top (i.e. right-side venting must have 1" clearance on left side and top) | | |

If necessary, take pictures of low voltage wiring connections and /or label individual wires. If re-routing is required, or a wire gets accidentally removed from the low voltage terminal strip, the wiring can easily be corrected by referring to the picture.

INSPECTION

1. Unpack all components of the kit.
2. Check carefully for any shipping damage. If any damage is found, this must be reported immediately and a claim made against the transportation company.
3. Check to be sure all components are in the package. Any missing components should be reported to your supplier at once and replaced with authorized components only.

Before installing the sound panels into furnace:

1. Dry-fit the side panels and bottom panel to ensure there is no interference with wiring and/or screws. Screws that penetrate the left, right and bottom panels should not extend more than 0.25" and have a blunt tip to avoid puncturing the panels. If necessary, remove screws that align with the frames and relocate, or use an alternative sealing method such as RTV, silicone, mastic, etc.,
2. Place side panels in the unit first, then fit the bottom panel between the two side panels. Side panels are designated for right and left installation and include cut-outs for the high voltage electrical J-box, dependent on your application.

NOTE: Panels should not be pierced, cut, or modified for maximum sound attenuation.

NOTE: Panels should be tight to one another and to the cabinet with minimal space between them.

Installing sound panels and front door panel:

1. Once dry-fit is complete, remove the bottom and side panels, clean cabinet sides and bottom with a clean damp rag for maximum magnetic adhesion.
2. Using an ink pen, record the model and serial number of the furnace on the label located on the front of the door. Be sure to write the numbers legibly, so they can be easily read by the homeowner.
3. Install the appropriate decorative badge on the new door.
4. Remove the panel from the door and place the appropriate wiring diagram on the door beneath the badge.
5. Re-install the panel in the door.
6. Install the supplied tinnerman clips over the engagement screw holes on the top vestibule cross-

Installer's Guide

member. Single stage furnaces may already have these installed, however S8X2 models will require the clips installed to ensure a robust front panel installation.

7. Install the side panels and the bottom panel.
8. Install the door assembly by inserting the bottom door

flange inside the furnace cabinet flange and pivot door upwards.

9. Insert the screws supplied with the kit and hand tighten with a ¼" nut driver.
10. Restore power to the furnace and verify operation before leaving the jobsite.

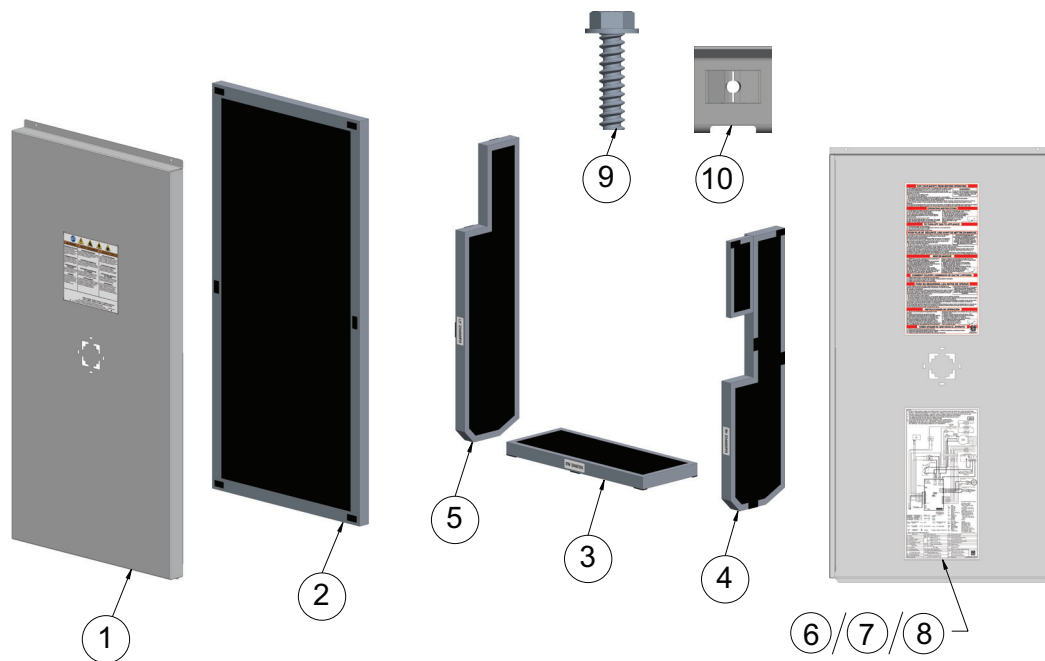

| ITEM | PART NUMBER | DESCRIPTION | QTY |
|------|-----------------|-----------------------------------|-----|
| 1 | D346677P01-P03 | Door Painted (A-C) | 1 |
| | D346677P05-P07* | Door Unpainted (A-C) | 1 |
| 2 | D346678P01-P03 | Sound Panel-Door (A-C) | 1 |
| 3 | D346679P01-P03 | Sound Panel-Bottom (A-C) | 1 |
| 4 | D346680P01 | Sound Panel-RH | 1 |
| 5 | D346681P01 | Sound Panel-LH | 1 |
| 6 | D345844P01 | Diagram-Wiring-S8X1 | 1 |
| | D346340P01* | Diagram-Wiring-A801X | 1 |
| 7 | D345847P01 | Diagram-Wiring-S8X2 | 1 |
| | D807006P01* | Brand Label-RunTru (Not Shown) | 1 |
| 8 | D346340P01 | Diagram-Wiring-S8B1 | 1 |
| | D932396P01* | Brand Label-Ameristar (Not Shown) | 1 |
| 9 | D345323P01 | Screw-no.8-Sheetmetal | 2 |
| 10 | D346313P01 | Clip-Tinnerman | 2 |

* Parts are specific to Ameristar/Runtru

MAINTENANCE

The sound panels should only be cleaned using a damp cloth with water. Do not use household cleaners, solvents, etc.,

About Trane and American Standard Heating and Air Conditioning

Trane and American Standard create comfortable, energy efficient indoor environments for residential applications. For more information, please visit www.trane.com or www.americanstandardair.com

The manufacturer has a policy of continuous data improvement and it reserves the right to change design and specifications without notice. We are committed to using environmentally conscious print practices.