

Low Temp AHU



Waterside

Our low-temp air handling units are specifically designed for cooler, freezer type applications where there is a requirement for air temperatures below 32°F.

Multiple AHU Applications

In order to prevent a decrease in airflow supply due to excessive frozen coils, the unit triggers a timed defrost cycle. While in defrost cycle, a communication cable allows other units to provide cooling; this ensures constant cooling at all times.



General Information

Airside Data

Ambient Operating Conditions	-20°F to 100°F ¹
Discharge Air Configuration	Horizontal
Flex Duct Connection Qty & Size	(1) 36 in. round ² (F0) units (4) 20 in. round (F1) units
Nominal Air Flow (cfm)	12,100 ³
Discharge Static Pressure @ Nominal Air Flow	1.5 in. ESP
Maximum Air Flow (cfm)	24,500
Discharge Static Pressure @ Maximum Air Flow	0.5 in. ESP

¹For ambient conditions below 40°F, glycol is recommended.

²With Long Throw Adapter

³Actual airflow is dependednt upon external static pressure requirement. Contact Trane Rental Services for specific airflow and static pressure information.

Subject to change at any time without notice or liability.

Electrical Data

Supply Motor Size	7.5 hp/11 A
Heater Circuit	37,730 W/47.35 A
Supply Motor Speed	1160 rpm
Fused Disconnect/Circuit Breaker	Yes
Number of Electrical Circuits	1
Voltage 460V	3-phase
Frequency	60 Hz
Minumum Circuit Ampacity (MCA)	61 A
Maximum Overcurrent Protection (MOP)	80 A

For additional electrical information contact Trane Rental Services.

Waterside Data

Water Connection Size	2.5 in.
Water Connection Type	Grooved
Drain Pipe Size	2.0 in. (F0 Units) 3/4 in. (F1 Units)
Drain Pipe Connection Type	Female Pipe Thread (F0 Units) Garden Hose (F1 Units)

Features and Benefits

F0 and F1 units only

Defrost – Prevents excessive frozen coils.

Three Way Valves – Simply allows the unit cooling coil to be bypassed while it is going through its defrost cycle.

Phase monitor and light – Ensures that line voltage is properly phased, protecting the equipment and greatly reducing troubleshooting time.

Small Footprint – Help bring units inside of the working area through double doors, elevators or other accessible areas.

F1 units only

VFD with Soft Start Bypass – This allows the installer to set exact supply airflow needs.

Daisy Chain Capable – Provides ease of installation and the ability to connect multiple units in series.

Cam-lok power connections – Allows the installer to make cable connections with a simple twist.

Filter Rack – Each unit is equipped with filters that are removable and replaceable. This allows the cooling coil to stay as clean as possible.

Lifting Frame – Allows for easy overhead lifting or from its own base that can be forklifted.

Supply Plenum – Each unit comes with (4) supply discharge connections to accommodate flex type ducts to help distribute air evenly across the building area.

Electronic Temperature Control – easily adjust temperature settings with the touch of a button.

Dimensions and Weights

	F0	F1
Length	9 ft. 6 in.	8 ft. 6 in.
Width without Long Throw Adapter	4 ft. 4 in.	5 ft. 5 in.
Width with Long Throw Adapter	6 ft. 0 in.	n/a
Height	7 ft. 2 in.	7 ft. 3 in.
Shipping Weight	2,463 lb.	3,280 lb.

Lifting Device: Forklift or Crane

Coil Capacity

Coil Type	Entering/Leaving Water Temp (°F)	Water Flow (gpm)	Pressure Drop (ft of H ² O)	Entering/Leaving Air Temp (°F)	Coil Capacity (BTUH)
Chilled Water	0/3.4	70	16.17	14/6.8	105,077
	0/3.9	90	17.39	16/9.7	158,567
	0/3.1	120	27.9	16/9.4	166,583

Selection based on 50% propylene glycol/water solution.
 Selection is required for actual AHU performance.
 Contact Trane Rental Services for specific selection information.
 Maximum waterside pressure is 150 psi (2.31' H²O = 1 psi)

Dimensions

F0 Unit

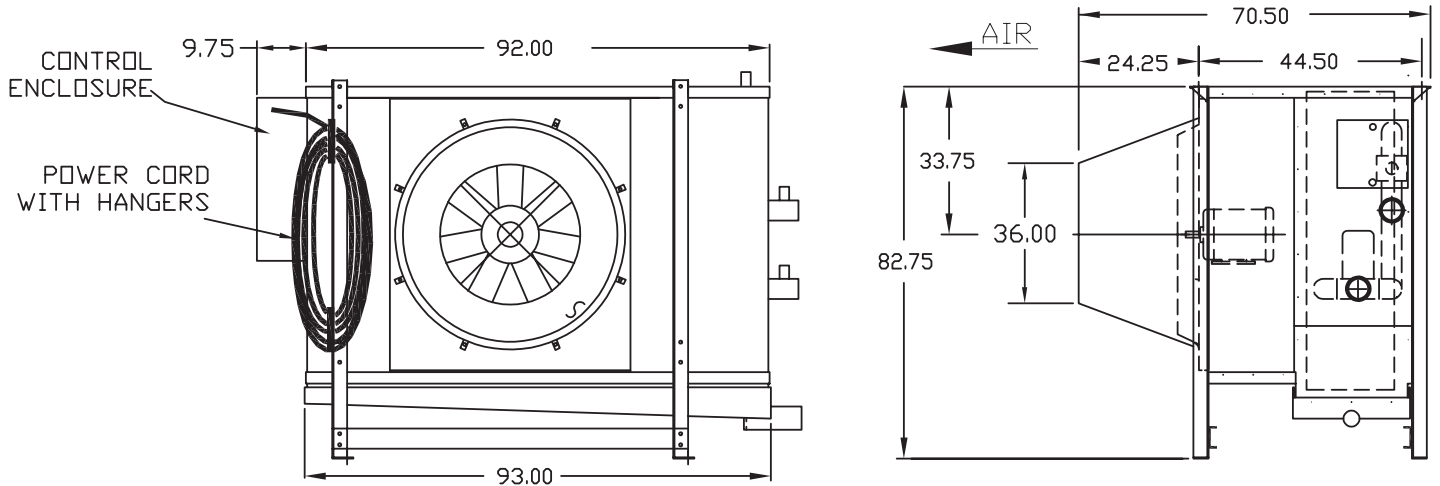

F1 Unit

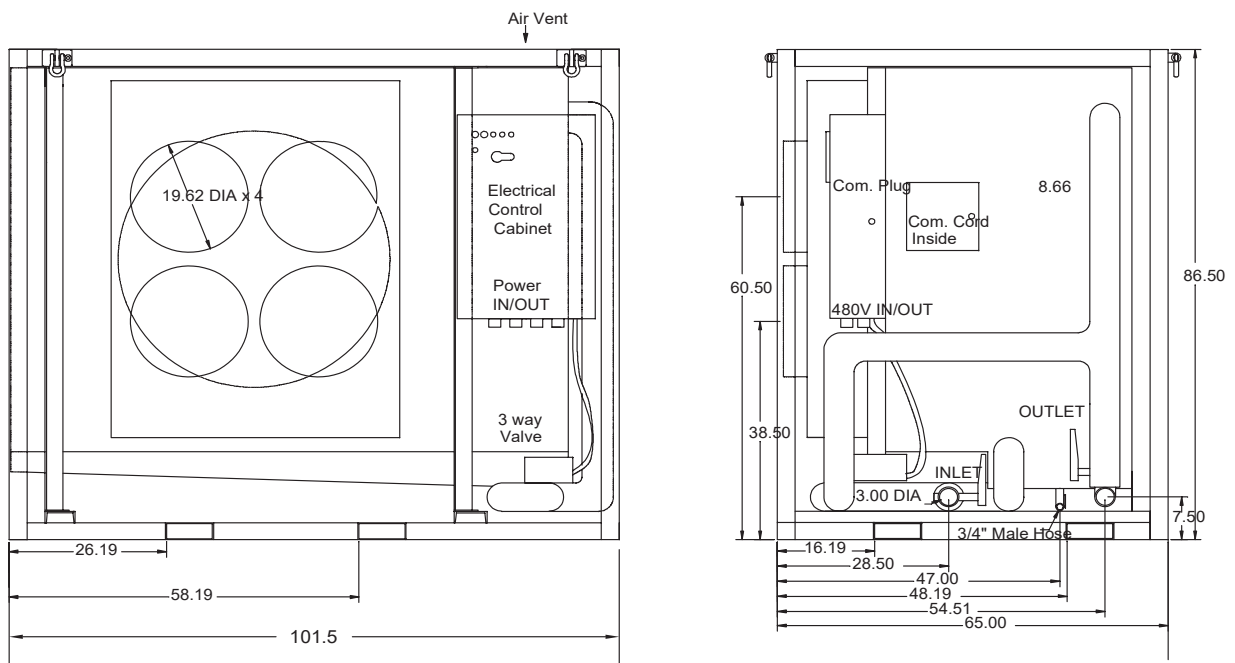

24hr Trane Rental Customer Service

800-755-5115



Trane – by Trane Technologies (NYSE: TT), a global climate innovator – creates comfortable, energy efficient indoor environments through a broad portfolio of heating, ventilating and air conditioning systems and controls, services, parts and supply. For more information, please visit trane.com or tranetechnologies.com.

All trademarks referenced in this document are the trademarks of their respective owners.

© 2020 Trane. All Rights Reserved.

AHU-SLB002-EN
04/30/2020