



Quick Reference Guide

**Water Source Heat Pump Axiom™**  
High Efficiency 0.75 to 6 Tons – EXHK/EXVK  
Two Stage High Efficiency 2 to 6 Tons – DXHK/DXVK



April 2024

**WSHP-PRC036A-EN**  
©2024 Trane



**1 Copyright**

This document and the information in it are the property of Trane, and may not be used or reproduced in whole or in part without written permission. Trane reserves the right to revise this publication at any time, and to make changes to its content without obligation to notify any person of such revision or change.

**Trademarks**

All trademarks referenced in this document are the trademarks of their respective owners.

**Table 1. List of options**

Factory Installed Options	Field Installed Options
1-inch or 2-inch Ducted Filter Rack	2-inch or 4-inch Ducted Filter Rack
Air-Fi® Wireless Communications	Ducted Panel
Deluxe 24V, Symbio™ 400-B Controls	Hose Kits (or ship separate hoses and valves)
Factory-mounted Isolation Valve	Low, Medium and High Electric Heat
Hot Gas Reheat	Pump Module
Matte or Foil Face Insulation	Pump Module Hose Kit
MERV 8 or 13 Filters	Thermostats or Zone Sensors
Polymer or Stainless Steel IAQ Drain Pan	Waterside Economizer
Recessed Unit Mounted Disconnect Switch	
Standard or Deluxe Sound Package	

**2**

**Table 2. General data - models EXHK009-024**

Model EXHK	009	012	015	018	024
Unit size width x depth x height (in.)	25.5 x 46 x 17.75	25.5 x 46 x 17.75	25.5 x 49 x 18.75	25.5 x 55 x 19.75	25.5 x 55 x 19.75
Compressor type	Rotary	Rotary	Rotary	Rotary	Scroll
Net weight (lbs.)	173	173	173	269	269
Ship weight (lbs.)	297	297	297	393	393
Filter size nominal (in.)	16 x 19	16 x 19	17 x 20	18 x 23	19 x 23
Water in/out size (FPT)	0.5	0.5	0.75	0.75	0.75
Condensate size (NPTI)	0.75	0.75	0.75	0.75	0.75
Blower wheel Size (in.)	9 x 8	9 x 8	10 x 8	10 x 9	10 x 9

**Table 3. General data - models EXHK030-070**

Model EXHK	030	036	042	048	060	070
Unit size width x depth x height (in.)	28 x 68 x 21.75	28 x 68 x 21.75	29.38 x 77.75 x 22.13	29.38 x 77.75 x 22.13	29.38 x 86.75 x 22.13	29.38 x 86.75 x 22.13
Compressor type	Scroll	Scroll	Scroll	Scroll	Scroll	Scroll
Net weight (lbs.)	315	316	408	386	437	434
Ship weight (lbs.)	460	461	587	565	616	613
Filter size nominal (in.)	20 x 30	20 x 30	20 x 20 (qty-2)	20 x 20 (qty-2)	30 x 20 20 x 20	30 x 20 20 x 20
Water in/out size (FPT)	1	1	1	1	1	1
Condensate size (NPTI)	0.75	0.75	0.75	0.75	0.75	0.75
Blower wheel Size (in.)	11 x 11	11 x 11	11 x 11	11 x 11	11 x 11	11 x 11

**Table 4. General data - models EXVK009-030**

Model EXVK	009	012	015	018	024	030
Unit size width x depth x height (in.)	21.5 x 21.5 x 34	21.5 x 21.5 x 34	21.5 x 23 x 36	21.5 x 26 x 38	21.5 x 26 x 38	24 x 32.5 x 42
Compressor type	Rotary	Rotary	Rotary	Rotary	Scroll	Scroll
Net weight (lbs.)	152	152	188	222	236	282
Ship weight (lbs.)	207	207	246	282	296	345
Filter size nominal (in.)	16 X 19	16 X 19	17 X 20	18 X 23	18 X 23	20 X 30
Water in/out size (FPT)	0.5	0.5	0.75	0.75	0.75	1

**3**

**Table 4. General data - models EXVK009-030 (continued)**

Model EXVK	009	012	015	018	024	030
Condensate size (NPTI)	0.75	0.75	0.75	0.75	0.75	0.75
Blower wheel Size (in.)	9 x 8	9 x 8	10 x 8	10 x 9	10 x 9	11 x 11

**Table 5. General data - models EXVK036-070**

Model EXVK	036	042	048	060	070
Unit size width x depth x height (in.)	24 x 32.5 x 42	25.4 x 32.5 x 49	25.4 x 32.5 x 49	25.4 x 32.5 x 55	25.4 x 32.5 x 55
Compressor type	Scroll	Scroll	Scroll	Scroll	Scroll
Net weight (lbs.)	284	356	350	370	432
Ship weight (lbs.)	347	421	415	439	501
Filter size nominal (in.)	20 X 30	27 X 30	27 X 30	30 X 33	30 X 33
Water in/out size (FPT)	1	1	1	1	1
Condensate size (NPTI)	0.75	0.75	0.75	0.75	0.75
Blower wheel Size (in.)	11 x 11	11 x 11	11 x 11	11 x 11	11 x 11

**Table 6. General data - models DXHK024-070**

Model DXHK	024	036	048	060	070
Unit size width x depth x height (in.)	25.5 x 55 x 19.75	28 x 68 x 21.75	29.38 x 77.75 x 22.13	29.38 x 86.75 x 22.13	29.38 x 86.75 x 22.13
Compressor type	Two-Stage Scroll	Two-Stage Scroll	Two-Stage Scroll	Two-Stage Scroll	Two-Stage Scroll
Net weight (lbs.)	271	318	387	440	436
Ship weight (lbs.)	395	463	566	619	615
Filter size nominal (in.)	18 x 23	20 x 30	20 x 20 (qty-2)	30 x 20 20 x 20	30 x 20 20 x 20
Water in/out size (FPT)	0.75	1	1	1	1
Condensate size (NPTI)	0.75	0.75	0.75	0.75	0.75
Blower wheel Size (in.)	10 x 9	11 x 11	11 x 11	11 x 11	11 x 11

**4**

**Table 7. General data - models DXVK024-070**

Model DXVK	024	036	048	060	070
Unit size width x depth x height (in.)	21.5 x 26 x 38	24 x 32.5 x 42	25.4 x 32.5 x 49	25.4 x 32.5 x 55	25.4 x 32.5 x 55
Compressor type	Two-Stage Scroll	Two-Stage Scroll	Two-Stage Scroll	Two-Stage Scroll	Two-Stage Scroll
Net weight (lbs.)	238	284	360	377	439
Ship weight (lbs.)	298	347	425	446	508
Filter size nominal (in.)	18 x 23	23 x 30	27 x 30	30 x 33	30 x 33
Water in/out size (FPT)	0.75	1	1	1	1
Condensate size (NPTI)	0.75	0.75	0.75	0.75	0.75
Blower wheel Size (in.)	10 x 9	11 x 11	11 x 11	11 x 11	11 x 11

**Table 8. ANSI/AHRI/ASHRAE/ISO13256-1 WLHP, GWHP and GLHP performance - 0.75 to 6 tons**

Model	Rated GPM	Rated CFM	Water Loop Heat Pump				Ground Water Heat Pump				Ground Loop Heat Pump			
			Cooling 86°F		Heating 68°F		Cooling 59°F		Heating 50°F		Full Cool 77°F		Full Heat 32°F	
			Capacity Btuh	EER	Capacity Btuh	COP	Capacity Btuh	EER	Capacity Btuh	COP	Capacity Btuh	EER	Capacity Btuh	COP
EXV/H009	2.25	285	8700	18.1	10700	6.4	9600	29.7	8500	5.2	9000	21.2	6100	3.9
EXV/H012	3.00	380	11400	17.1	14300	5.9	12500	26.1	11500	5.0	11900	19.8	8500	3.8
EXV/H015	3.75	475	15800	16.3	19000	5.3	17100	24.6	15600	4.6	16200	18.7	11800	3.7
EXV/H018	4.50	570	18900	17.5	23000	5.4	21100	29.6	18600	4.8	19700	20.8	14400	3.9
EXV/H024	6.00	760	25300	18.1	32000	5.6	27400	28.4	25900	4.8	26200	21.2	19400	3.8
EXV/H030	7.50	950	30200	17.9	37500	5.7	34500	29.3	30100	5.0	31800	21.3	22900	4.2
EXV/H036	9.00	1140	35000	17.8	43600	5.6	39500	28.4	35500	4.9	36600	20.8	27200	4.1
EXV/H042	10.50	1330	42000	17.8	48800	5.9	45300	27.7	39300	5.1	43300	20.9	30800	4.1
EXV/H048	12.00	1520	45300	17.5	51800	5.8	48300	26.5	41800	4.9	46900	20.3	33900	4.0
EXV/H060	15.00	1900	60600	17.0	72100	5.4	66800	26.2	58700	4.7	62700	19.7	45200	3.8
EXV/H070	17.50	2215	63400	17.6	77000	5.5	67700	25.1	62200	4.7	65900	20.1	48800	3.9

**Note:** Rated in accordance ANSI/AHRI/ASHRAE/ISO13256-1. Certified conditions are 80.6°F DB/66.2°F WB EAT in cooling and 68°F DB/59°F WB EAT in heating. Entering liquid temperature in cooling is 86°F for Water Loop, 77°F for Ground Loop (full load), 68°F for Ground Loop (part load), and 59°F for Ground Water. Entering liquid temperature in heating is 68°F for Water Loop, 32°F for Ground Loop (full load), 41°F for Ground Loop (part load), and 50°F for Ground Water.

**Table 9. ANSI/AHRI/ASHRAE/ISO13256-1 WLHP, GWHP and GLHP performance - 2 to 6 tons**

Model	Load	Rated GPM	Rated CFM	Water Loop Heat Pump				Ground Water Heat Pump				Ground Loop Heat Pump			
				Cooling 86°F		Heating 68°F		Cooling 59°F		Heating 50°F		Full Cool 77°F		Full Heat 32°F	
				Capacity Btuh	EER	Capacity Btuh	COP	Capacity Btuh	EER	Capacity Btuh	COP	Capacity Btuh	EER	Capacity Btuh	COP
DXV/H024	Full	6.0	760	25400	18.8	31100	5.7	27100	28.1	25000	5.0	25700	21.3	18900	4.1
DXV/H024	Part	6.0	608	18100	19.5	21700	5.9	19700	33.1	17900	5.0	19100	27.5	16300	4.6
DXV/H036	Full	9.0	1140	32100	17.5	41800	6.0	36700	27.5	33600	5.1	33800	20.5	25400	4.2
DXV/H036	Part	9.0	912	22600	17.5	30300	6.6	26300	31.8	24100	5.3	25400	26.2	20600	4.7
DXV/H048	Full	12.0	1520	44800	17.3	53700	6.0	49500	26.6	42900	5.1	46300	19.8	32300	4.2
DXV/H048	Part	12.0	1216	31900	17.1	38700	6.4	34900	26.6	30800	5.2	34600	24.2	26400	4.4
DXV/H060	Full	15.0	1900	54500	18.2	67000	6.1	60100	26.5	53800	5.2	56500	20.7	41000	4.2
DXV/H060	Part	15.0	1520	38100	18.3	48000	6.7	43100	30.2	37900	5.4	41900	26.0	32000	4.5
DXV/H070	Full	17.5	2215	61800	16.0	81400	5.5	67000	22.5	67300	4.8	65100	18.5	51700	4.0
DXV/H070	Part	17.5	1772	44600	17.4	55700	5.9	48100	26.4	46100	4.9	48100	23.6	41000	4.3

**Note:** Performance data EXVK 0.5 Ton or 0.75 Ton Rated in accordance with ANSI/AHRI/ASHRAE/ISO13256-1. Certified conditions are 80.6°F DB/66.2°F WB EAT in cooling and 68°F DB/59°F WB EAT in heating. Entering liquid temperature in cooling is 86°F for Water Loop, 77°F for Ground Loop (full load), 68°F for Ground Loop (part load), and 59°F for Ground Water. Entering liquid temperature in heating is 68°F for Water Loop, 32°F for Ground Loop (full load), 41°F for Ground Loop (part load), and 50°F for Ground Water.

**Table 10. Electrical data - 0.75 to 6 tons, EX\*009-070**

Model No.	Unit Volts	Blower Motor HP	Minimum Circuit Ampacity	Maximum Overcurrent Protective Device
EXV/H009	208-230/60/1	1/3	6/6	15/15
EXV/H009	265/60/1	1/3	5	15
EXV/H012	208-230/60/1	1/3	9/9	15/15
EXV/H012	265/60/1	1/3	6	15
EXV/H015	208-230/60/1	1/3	16/16	25/25
EXV/H015	265/60/1	1/3	9	15
EXV/H018	208-230/60/1	1/2	21/21	30/30

**Table 10. Electrical data - 0.75 to 6 tons, EX\*009-070 (continued)**

Model No.	Unit Volts	Blower Motor HP	Minimum Circuit Ampacity	Maximum Overcurrent Protective Device
EXV/H018	265/60/1	1/2	11	15
EXV/H024	208-230/60/1	1/2	17/17	25/25
EXV/H024	265/60/1	1/2	15	20
EXV/H024	208-230/60/3	1/2	12/12	15/15
EXV/H024	460/60/3	1/2	6	15
EXV/H030	208-230/60/1	3/4	18/18	30/30
EXV/H030	265/60/1	3/4	16	25
EXV/H030	208-230/60/3	3/4	14/14	20/20
EXV/H030	460/60/3	3/4	7	15
EXV/H036	208-230/60/1	3/4	20/20	30/30
EXV/H036	265/60/1	3/4	18	25
EXV/H036	208-230/60/3	3/4	19/19	30/30
EXV/H036	460/60/3	1	8	15
EXV/H042	208-230/60/1	3/4	22/22	35/35
EXV/H042	208-230/60/3	3/4	18/18	30/30
EXV/H042	460/60/3	1	9	15
EXV/H048	208-230/60/1	1	27/27	40/40
EXV/H048	208-230/60/3	1	20/20	30/30
EXV/H048	460/60/3	1	9	15
EXV/H060	208-230/60/1	1	32/32	50/50
EXV/H060	208-230/60/3	1	25/25	40/40
EXV/H060	460/60/3	1	12	15
EXV/H070	208-230/60/1	1	36/36	50/50
EXV/H070	208-230/60/3	1	26/26	40/40
EXV/H070	460/60/3	1	12	15

**Table 11. Electrical data - 2 to 6 tons, DX\*024-070**

Model No.	Unit Volts	Blower Motor HP	Minimum Circuit Ampacity	Maximum Overcurrent Protective Device
DXV/H024	208-230/60/1	1/2	15/15	25/25
DXV/H024	265/60/1	1/2	12	15
DXV/H024	208-230/60/3	1/2	10/10	15/15
DXV/H024	460/60/3	1/2	6	15
DXV/H036	208-230/60/1	3/4	21/21	35/35
DXV/H036	265/60/1	3/4	15	25
DXV/H036	208-230/60/3	3/4	13/13	20/20
DXV/H036	460/60/3	1	7	15
DXV/H048	208-230/60/1	1	26/26	40/40
DXV/H048	208-230/60/3	1	18/18	25/25
DXV/H048	460/60/3	1	11	15
DXV/H060	208-230/60/1	1	30/30	45/45
DXV/H060	208-230/60/3	1	24/24	35/35
DXV/H060	460/60/3	1	12	15
DXV/H070	208-230/60/1	1	38/38	60/60
DXV/H070	208-230/60/3	1	24/24	35/35
DXV/H070	460/60/3	1	12	15

**Figure 1. Clearances – EXHK/DXHK 0.75 to 6 tons**

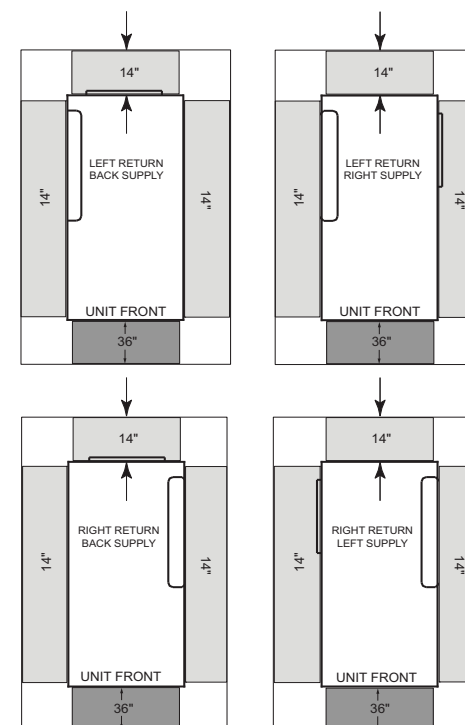

A minimum 14-inch clearance for servicing the unit is required for all EXH 0.75 to 6 tons configurations from other mechanical and electrical equipment (where shown) to enable panel removal from the unit for service/maintenance ability. The optimum clearance required is 20 inches.

**Figure 2. Clearances – EXVK/DXVK 0.75 to 6 tons**

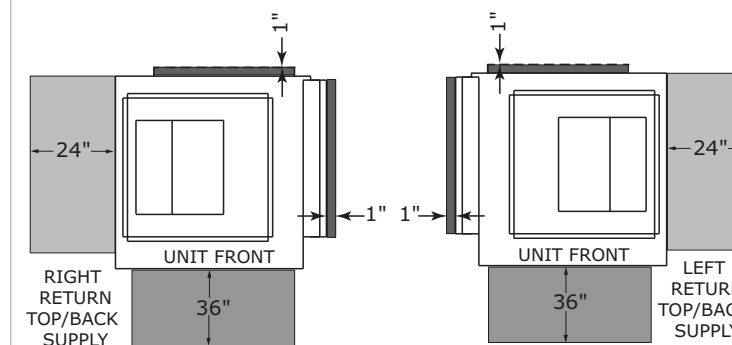

A 24-inch clearance from other mechanical and electrical equipment (where shown) is recommended for most unit configurations. This will enable panel removal from the unit for service/maintenance. The 24-inch side clearance on EXVK/DXVK 0.75-6T models is for optimal access only. Side clearance is not a requirement as most components can be accessed from the front of the unit. A 1-inch minimum clearance between the filter rack and any obstacle is required for units in a free return application to provide proper air flow to the air-to-refrigerant coil. A 12-inch minimum clearance between the filter rack and any obstacle should be provided to properly attached ductwork. The 1-inch dimension shown in the back of the unit represents the supply duct collar for the back supply option. This clearance is needed to clear these flanges.

Trane - by Trane Technologies (NYSE: TT), a global climate innovator - creates comfortable, energy efficient indoor environments for commercial and residential applications. For more information, please visit [trane.com](http://trane.com) or [tranetechnologies.com](http://tranetechnologies.com).

Trane has a policy of continuous product and product data improvement and reserves the right to change design and specifications without notice. We are committed to using environmentally conscious print practices.