



## Installation Instructions

# Roof Curb

## Water Source Heat Pump Axiom Rooftop 12.5 to 25 Tons

<b>Model Number:</b>	<b>Used With:</b>
FIACURB404*	GSJ150-300
FIACURB804*	GSJ150-300

**SAFETY WARNING**  
Only qualified personnel should install and service the equipment. The installation, starting up, and servicing of heating, ventilating, and air-conditioning equipment can be hazardous and requires specific knowledge and training. Improperly installed, adjusted or altered equipment by an unqualified person could result in death or serious injury. When working on the equipment, observe all precautions in the literature and on the tags, stickers, and labels that are attached to the equipment.

September 2023

WSHP-SVN012B-EN

©2023 Trane



### 1 Warnings, Cautions, and Notices

Read this manual thoroughly before operating or servicing this unit. Safety advisories appear throughout this manual as required. Your personal safety and the proper operation of this machine depend upon the strict observance of these precautions.

The three types of advisories are defined as follows:

- WARNING** Indicates a potentially hazardous situation which, if not avoided, could result in death or serious injury.
- CAUTION** Indicates a potentially hazardous situation which, if not avoided, could result in minor or moderate injury. It could also be used to alert against unsafe practices.
- NOTICE** Indicates a situation that could result in equipment or property-damage only accidents.

#### Important Environmental Concerns

Scientific research has shown that certain man-made chemicals can affect the earth's naturally occurring stratospheric ozone layer when released to the atmosphere. In particular, several of the identified chemicals that may affect the ozone layer are refrigerants that contain Chlorine, Fluorine and Carbon (CFCs) and those containing Hydrogen, Chlorine, Fluorine and Carbon (HCFCs). Not all refrigerants containing these compounds have the same potential impact to the environment. Trane advocates the responsible handling of all refrigerants.

#### Important Responsible Refrigerant Practices

Trane believes that responsible refrigerant practices are important to the environment, our customers, and the air conditioning industry. All technicians who handle refrigerants must be certified according to local rules. For the USA, the Federal Clean Air Act (Section 608) sets forth the requirements for handling, reclaiming, recovering and recycling of certain refrigerants and the equipment that is used in these service procedures. In addition, some states or municipalities may have additional requirements that must also be adhered to for responsible management of refrigerants. Know the applicable laws and follow them.

### 2 WARNING

**Proper Field Wiring and Grounding Required!**  
Failure to follow code could result in death or serious injury. All field wiring MUST be performed by qualified personnel. Improperly installed and grounded field wiring poses FIRE and ELECTROCUTION hazards. To avoid these hazards, you MUST follow requirements for field wiring installation and grounding as described in NEC and your local/state/national electrical codes.

### WARNING

**Personal Protective Equipment (PPE) Required!**  
Failure to wear proper PPE for the job being undertaken could result in death or serious injury. Technicians, in order to protect themselves from potential electrical, mechanical, and chemical hazards, MUST follow precautions in this manual and on the tags, stickers, and labels, as well as the instructions below:

- Before installing/servicing this unit, technicians MUST put on all PPE required for the work being undertaken (Examples; cut resistant gloves/sleeves, butyl gloves, safety glasses, hard hat/bump cap, fall protection, electrical PPE and arc flash clothing). ALWAYS refer to appropriate Safety Data Sheets (SDS) and OSHA guidelines for proper PPE.
- When working with or around hazardous chemicals, ALWAYS refer to the appropriate SDS and OSHA/GHS (Global Harmonized System of Classification and Labeling of Chemicals) guidelines for information on allowable personal exposure levels, proper respiratory protection and handling instructions.
- If there is a risk of energized electrical contact, arc, or flash, technicians MUST put on all PPE in accordance with OSHA, NFPA 70E, or other country-specific requirements for arc flash protection, PRIOR to servicing the unit. NEVER PERFORM ANY SWITCHING, DISCONNECTING, OR VOLTAGE TESTING WITHOUT PROPER ELECTRICAL PPE AND ARC FLASH CLOTHING. ENSURE ELECTRICAL METERS AND EQUIPMENT ARE PROPERLY RATED FOR INTENDED VOLTAGE.

### 3 WARNING

**Follow EHS Policies!**  
Failure to follow instructions below could result in death or serious injury.

- All Trane personnel must follow the company's Environmental, Health and Safety (EHS) policies when performing work such as hot work, electrical, fall protection, lockout/tagout, refrigerant handling, etc. Where local regulations are more stringent than these policies, those regulations supersede these policies.
- Non-Trane personnel should always follow local regulations.

#### Copyright

This document and the information in it are the property of Trane, and may not be used or reproduced in whole or in part without written permission. Trane reserves the right to revise this publication at any time, and to make changes to its content without obligation to notify any person of such revision or change.

#### Trademarks

All trademarks referenced in this document are the trademarks of their respective owners.

#### Revision History

Water in / out NPTI information for Models GSJ240 and GSJ300 updated to 2.00NPTI.

#### General Information

This manual describes the layout and installation procedures required to properly assemble and install the roof curb. Illustrations in Figure 1, p. 5 are provided for dimensional data regarding roof opening construction. Each curb package ships un-assembled, along with the required hardware and gasketing material.

Roof insulation, cant strips, flashing (if desired) and nails must be furnished by the installing contractor.

### 4 Inspection

1. Unpack all components of the kit.
2. Check carefully for shipping damage. If any damage is found, report it immediately, and file a claim against the transportation company.
3. Visually inspect the components for shipping damage as soon as possible after delivery, before it is stored. Concealed damage must be reported within 15 days.
4. If concealed damage is discovered, stop unpacking the shipment.
5. Do not remove damaged material from the receiving location. Take photos of the damage, if possible. The owner must provide reasonable evidence that the damage did not occur after delivery.
6. Notify the carrier terminal of damage immediately by phone and by mail. Request an immediate joint inspection of the damage by the carrier and the consignee.
7. Do not attempt to repair any damaged parts until the parts are inspected by a carrier representative.

#### Parts List

Table 1. Parts list

Qty	Description
2	Side rails
2	End rails
2	Side curb flanges
1	End curb flange
4	Insulated block-off panels on FIACURB404*, FIACURB804*
1	Gasketing material
1	Bag of required fasteners
6	Insulation divider/support panels on FIACURB404*, FIACURB804*

### 5 Roof Opening

For safety and sound considerations, do not cut out the entire roof deck within the curb area.

#### Roof Support

**WARNING**  
**Risk of Roof Collapsing!**  
Failure to ensure proper structural roof support could cause the roof to collapse, which could result in death or serious injury and property damage. Confirm with a structural engineer that the roof structure is strong enough to support the combined weight of the roof curb and the unit. Refer to Table 3, p. 1 and Table 4, p. 1 for typical unit and curb weights.

The roof must be capable of adequately supporting the weight of the rooftop unit and accessories, as well as that of the curb. See Figure 2, p. 1 and Table 3, p. 1 for specific center-of gravity and corner weight information.

Units may be set either perpendicular or parallel to roof support members. The combined weight of the unit, accessories, and curb should be evenly spaced between a minimum of two supports.

Confirm position of the curb on the roof support does not interfere with the clearance required for the supply/return ductwork. See Figure 8, p. 2 for ductwork location.

#### Clearances

Recommended clearances for single-unit installation are illustrated in Figure 1, p. 1. These minimum requirements are not only an important consideration when determining unit placement, but are also essential to ensure adequate serviceability, maximum capacity, and peak operating efficiency.

Any reduction of the unit clearances indicated in this illustration may result in condenser coil starvation, or the recirculation of warm condenser air. Actual clearances which appear to be inadequate should be reviewed with a local sales engineer.

### 6 Figure 1. Clearances

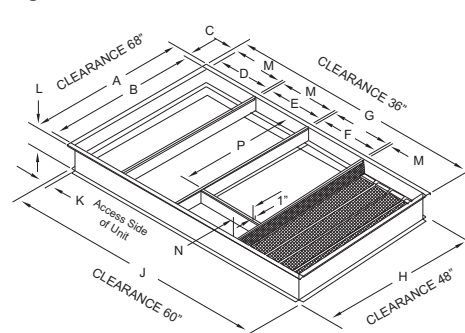

### 7 Figure 2. Center of gravity

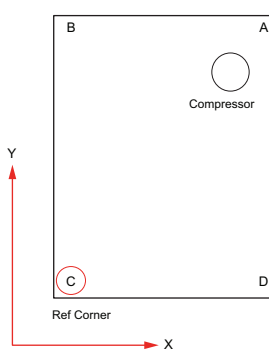

**Note:** Corner weights are given for information only. Unit is to be supported full perimeter by a curb or equivalent frame support.

### 7 Table 2. Dimensional data (inches)

Units	A	B	C	D	E	F	G	H	J	K	L	M	N	P
FIACURB404*/FIACURB804*	80 5/8	77	1 13/16	22 1/4	23 1/4	28 9/16	116 7/8	81	117 3/16	2	14 1/16 (a) (b)	1	7 1/2	69 1/2

(a) FIACURB404\* Dimension (L) 14 1/16  
(b) FIACURB804\* Dimension (L) 18 1/16

### Table 3. Model unit and corner weights (lb) and center of gravity dimensions (in.)

Model	Width (in.)	Depth (in.)	Height (in.)	Weight (lbs)	Shipping Weight (lbs)	Corner Weights				Center of Gravity		Water In / Out NPTI (in.)
						A	B	C	D	X (in.)	Y (in.)	
GSJ150	123.0	87.0	59.0	1969	2219	675	495	429	370	50	70	1.50 NPTI
GSJ180	123.0	87.0	59.0	1969	2219	675	495	429	370	50	70	
GSJ240	123.0	87.0	66.0	2210	2460	731	537	403	539	50	71	
GSJ300	123.0	87.0	66.0	2210	2460	731	537	403	539	50	71	

**Note:** Corner weights and center of gravity do not include accessories.

### Table 4. Curbs weight (net lbs.)

Curb	Weight
FIACURB404*	235
FIACURB804*	265

#### Installation

Read the entire manual carefully to become familiar with the roof curb installation procedures. If the roof curb will be mounted on a new building, it can be assembled at any convenient location and installed as soon as the roof support members are in place. The curb should be placed directly on the roof support members.

Use tack welding or other suitable fastening method to secure the roof curb in place. The curb can also be mounted on a roof deck. In this case, additional nailing plates must be provided directly below the

flanges of the curb to give further support, and to minimize vibration. See [Figure 3, p. 2](#) and [Figure 4, p. 2](#).

### Roof Curb Assembly

1. Break the bands and remove the wood holding the curb assembly together.
2. Set the four perimeter pieces, (two end rails and two side rails), together to form the curb.
3. Using screws provided, attach the corners by allowing the angle of the side rail to fit inside the end rail. Insert three screws in each corner (see [Figure 5, p. 2](#)).
4. Insert screws through the end rails and into the corner angle of the side rails.
5. Mount duct flanges on the two side rails and one of the end rails. Mount with screws provided through the exterior panel and into the flange. The duct flanges should be mounted with the flange next to the rails pointing down (see [Figure 6, p. 2](#)).

**Important:** The end of the curb with curb flange attached MUST be used as the return air end.

6. Locate the cross support pieces with the curb flange down. See dimensional drawings in [Figure 1, p. 1](#). The flanges on the cross supports must match the duct.
7. Use three screws at the end of each cross support. Screws must enter from the exterior of the curb.

**Note:** Measure supply and return dimensions to confirm that the correct holes in the side rails are used.

8. Lay the three or four insulated block-offs, (with the insulation side up), cross ways in the section of the curb that will support the compressor end of the unit. They will rest on the duct flanges.

**Important:** If the cross members have been located on the wrong end of the curb, the insulated block-off next to the end of the curb will not lie flat. Apply the provided gasket material directly to the rails and cross members as shown in [Figure 7, p. 2](#). Gasket should be cut and put together at the corners.

**Note:** Do not round the corners with the gasket material.

9. Curb is now ready to be installed around the roof opening.

### Curb Installation

1. Set the curb in the proper position around the roof opening.
2. The curb must be leveled to confirm proper flow of condensate from the unit. The maximum pitch of the roof curb down from the access side of the unit is 1/16 inch per foot. See [Figure 1, p. 1](#). To check the flatness of the curb, stretch lines diagonally between opposite corners of the assembled curb. The distance between the lines (at their point of intersection) should not exceed 1/4 inch. If the lines touch, reverse them (place the top line on the bottom and the bottom line on top), and recheck the point of intersection. Shim under the curb as necessary.
3. Check the curb assembly for squareness by measuring diagonally between opposite corners of the curb. The distance indicated by these measurements should be the same.
4. Fasten the curb to the roof support members, or roof deck. See [Figure 3, p. 2](#) and [Figure 4, p. 2](#).
5. Bring the roof material up to the curb as shown in [Figure 3, p. 2](#) and [Figure 4, p. 2](#). Place a piece of rigid insulation around the curb and fasten it (from the inside), with nails.
6. Install cant strips as shown in [Figure 3, p. 2](#) of either 4 inch x 4 inch wood (cut diagonally in half), or other suitable material. With the cant strips in place, bring the roofing felts up to the top of the curb nailing strips. Push the felts up under the lip of the curb and nail them tightly into position.

**Note:** Any pipes or electrical conduits which extend through the roof must be flashed with a sleeve and roof flange extending a minimum of 8 inches above the roof surface.

7. The roof curb installation is now complete and ready for ductwork and unit installation.

**Figure 3. Typical installation on new construction**

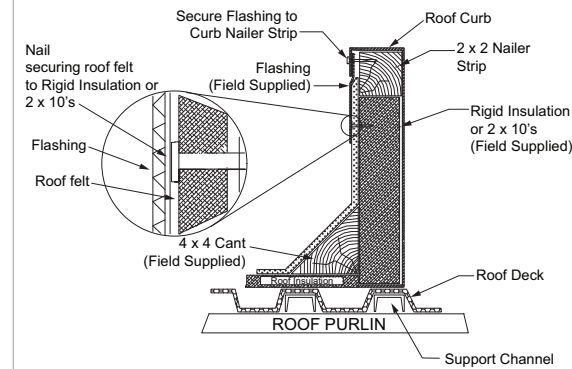

**Figure 4. Typical installation on existing construction**

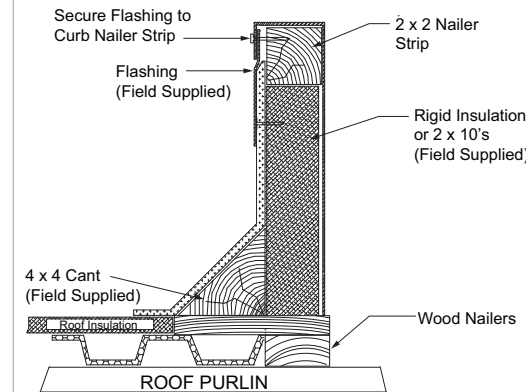

**Figure 5. Curb rail assembly A**

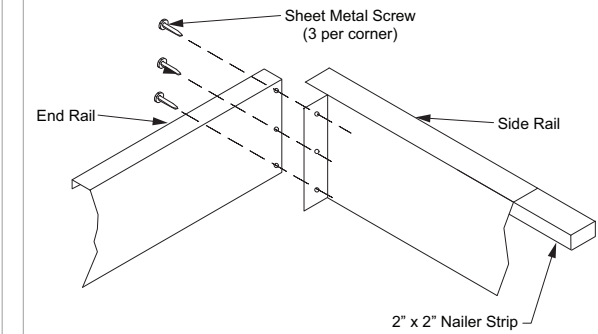

**Figure 6. Curb rail assembly B**

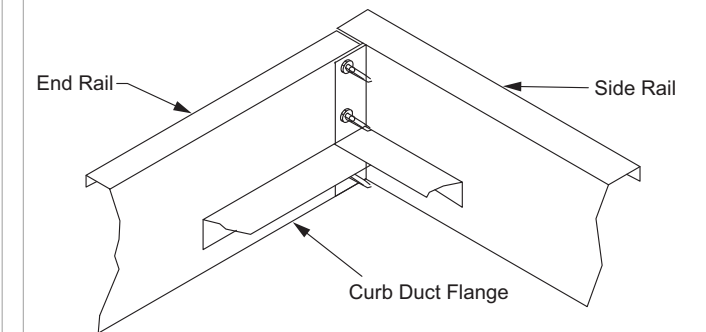

**Figure 7. Installing gasket material**

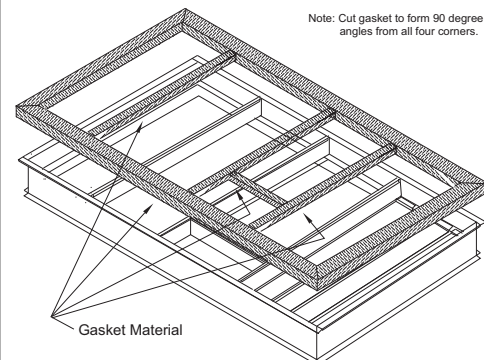

### Supply and Return Air Ductwork

- When flexible duct is not desired, metal or fiberboard duct may be installed.
- The metal or fiberboard duct must conform to all local building codes.
- The duct must be hung from the curb flanges inside the curb walls.

**Important:** Duct work must be hung from the curb flanges. It must not be installed over the top edges of the curb.

- When the duct is fabricated it should be large enough to cover the openings for the return and supply sides of the unit, but the flanges must be narrow enough to slide down inside the curb.

**Important:** All duct work attached to the curb, must be in place and secured before the unit is set.

- To verify proper duct construction and installation, SMACNA recommendations should be closely followed.

### Notes:

- All field fabricated panels used must be insulated.
- Fabricated duct flange must rest on inside of curb on flange, as shown, after installation.

**Table 5. Supply and return air ductwork dimensions**

Units	A	B	C	D	E	F	G
FIACURB404*/FIACURB804*	73 7/16	19 5/16	66 1/2	26 5/16	1	14 1/16 (a) (b)	7 7/16

(a) FIACURB404\* Dimension (F) 14 1/16

(b) FIACURB804\* Dimension (F) 18 1/16

**Figure 8. Duct dimensions**

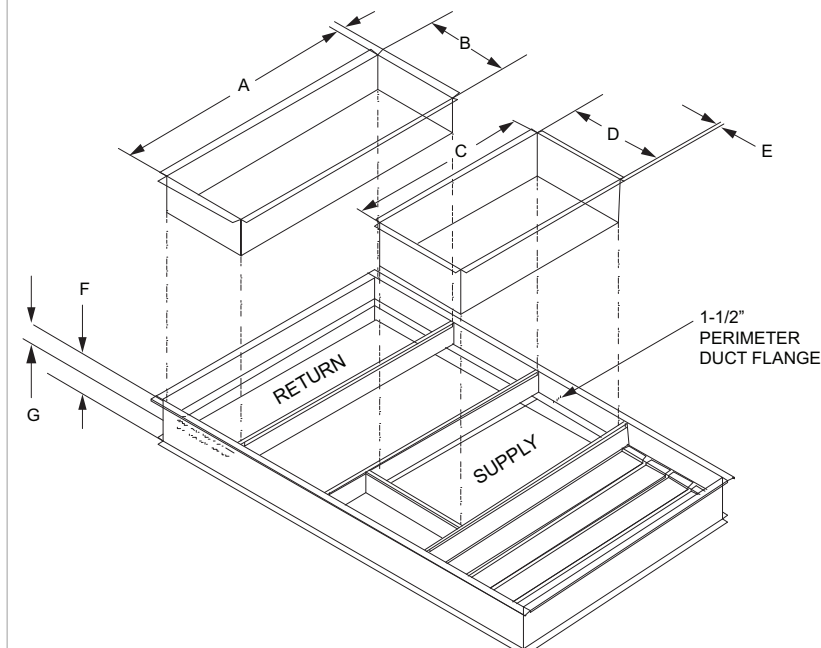

Trane - by Trane Technologies (NYSE: TT), a global climate innovator - creates comfortable, energy efficient indoor environments for commercial and residential applications. For more information, please visit [trane.com](http://trane.com) or [tranetechnologies.com](http://tranetechnologies.com).

Trane has a policy of continuous product and product data improvement and reserves the right to change design and specifications without notice. We are committed to using environmentally conscious print practices.